

FEE \$10.00

PERMIT # 12474



FENCE PERMIT
GRAND JUNCTION COMMUNITY DEVELOPMENT DEPARTMENT

THIS SECTION TO BE COMPLETED BY APPLICANT

PROPERTY ADDRESS: 2687 Malibu Dr
PROPERTY TAX NO: 2701-264-17-006
SUBDIVISION:
PROPERTY OWNER: Mrs. Cherry
OWNER'S PHONE: 970-242-2683
OWNER'S ADDRESS: 2687 Malibu Dr
CONTRACTOR NAME: Taylor Fence Co
CONTRACTOR'S PHONE: 970-241-1473
CONTRACTOR'S ADDRESS: 832 2 1/2 Rd
FENCE MATERIAL & HEIGHT: 6' PVC

PLOT PLAN

See Attached

Plot plan must show property lines and property dimensions, all easements, all rights-of-way, all structures, all setbacks from property lines, & fence height(s). NOTE: PROPERTY LINE IS LIKELY ONE FOOT OR MORE BEHIND THE SIDEWALK.

THIS SECTION TO BE COMPLETED BY COMMUNITY DEVELOPMENT DEPARTMENT STAFF

ZONE RSF-4
SETBACKS: Front 20' from property line (PL) or
SPECIAL CONDITIONS
from center of ROW, whichever is greater.
Side 0' from PL Rear 0' from PL

Fences exceeding six feet in height require a separate permit from the City/County Building Department. A fence constructed on a corner lot that extends past the rear of the house along the side yard or abuts an alley requires approval from the City Engineer (Section 4.1.J of the Grand Junction Zoning and Development Code).

The owner/applicant must correctly identify all property lines, easements, and rights-of-way and ensure the fence is located within the property's boundaries. Covenants, conditions, restrictions, easements and/or rights-of-way may restrict or prohibit the placement of fence(s). The owner/applicant is responsible for compliance with covenants, conditions, and restrictions which may apply. Fences built in easements may be subject to removal at the property owner's sole and absolute expense. Any modification of design and/or material as approved in this fence permit must be approved, in writing, by the Community Development Department Director.

I hereby acknowledge that I have read this application and the information and plot plan are correct; I agree to comply with any and all codes, ordinances, laws, regulations, or restrictions which apply. I understand that failure to comply shall result in legal action, which may include but not necessarily be limited to removal of the fence(s) at the owner's cost.

Applicant's Signature Donna M Mathieu
Community Development's Approval [Signature]
City Engineer's Approval (if required)

Date 9-4-03
Date 9/9/03
Date

VALID FOR SIX MONTHS FROM DATE OF ISSUANCE (Section 2.2.E.1.d Grand Junction Zoning & Development Code)
(White: Planning) (Yellow: Customer) (Pink: Code Enforcement)

Locate Eastside of House
Fence paint

WORK ORDER

TAYLOR FENCE COMPANY

TO Mrs Cherry
2687 Malibu Drive
G J Co 81506

DATE 8-12²⁰ 03 W 6502

PHONE 242-2683

CUSTOMER'S ORDER NO.

TERMS Paradise Hills Sub off Lanai Dr

SALESMAN Jerry O

QUANTITY	DESCRIPTION	PRICE
48'	6 white Basket weave pvc must do wk sept	15th
72	7/8 x 6" x 8' Rails	
6	7/8 x 3" x 6' mid Rails plugs + screws locate #	
5	5" x 5" x 9' BW Lines	
2	5" x 5" x 9' BW Ends	
11	5" Flat caps	
32'	1 1/2 x 5 1/2 2 Rail pvc	
4	1 1/2 x 5 1/2 x 16' Rails	
3	5" x 5" x 5'6" 2 Hole Lines	
1	5" x 5" x 5'6" 2 Hole End	
2	1 1/2 x 5 1/2 Rail mounts + screws	

Mr Perry will need to cut back his Evergreen Trees match the height of the ex Basket weave 2 Rail Fence

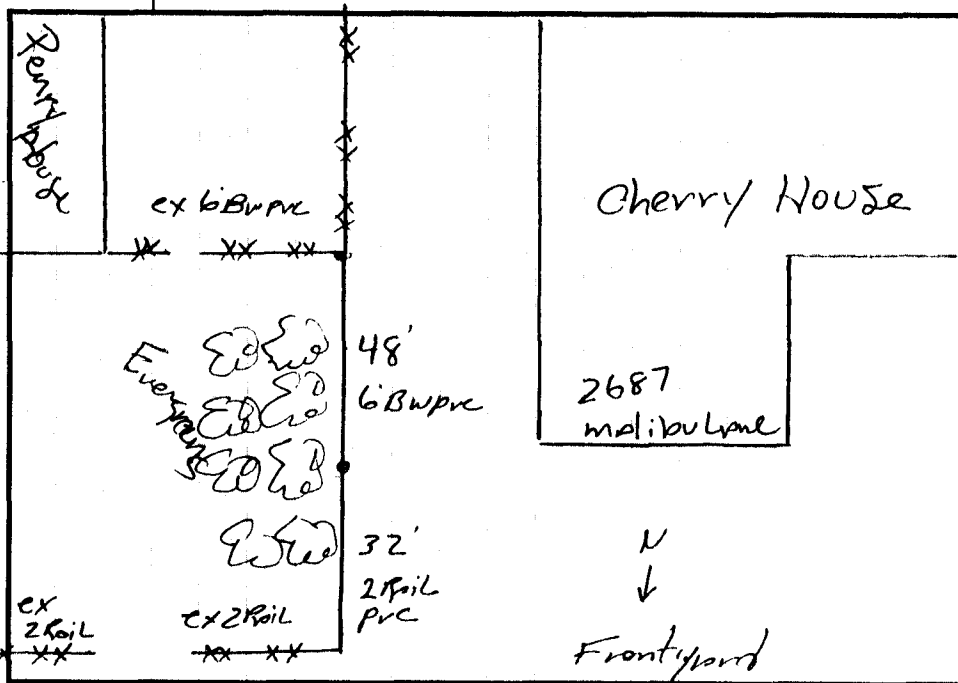

← Malibu Drive →