

FEE \$10.00

PERMIT # 13266



FENCE PERMIT
GRAND JUNCTION COMMUNITY DEVELOPMENT DEPARTMENT

Handwritten number 0 in a circle

THIS SECTION TO BE COMPLETED BY APPLICANT

PROPERTY ADDRESS: 339 Redcliff Ct.
PROPERTY TAX NO: 2947-351-19-011
SUBDIVISION: Canyon View Phase IV
PROPERTY OWNER: Mr. Ashbeck
OWNER'S PHONE: 970-244-1437
OWNER'S ADDRESS: 339 Redcliff Ct.
CONTRACTOR NAME: Taylor Fence Co.
CONTRACTOR'S PHONE: 970-241-1473
CONTRACTOR'S ADDRESS: 832 2 1/2 Rd
FENCE MATERIAL & HEIGHT: 4' Cedar

PLOT PLAN

See Attached

Plot plan must show property lines and property dimensions, all easements, all rights-of-way, all structures, all setbacks from property lines, & fence height(s). NOTE: PROPERTY LINE IS LIKELY ONE FOOT OR MORE BEHIND THE SIDEWALK.

THIS SECTION TO BE COMPLETED BY COMMUNITY DEVELOPMENT DEPARTMENT STAFF

ZONE PD
SETBACKS: Front from property line (PL) or
SPECIAL CONDITIONS
Side from PL Rear from PL

Fences exceeding six feet in height require a separate permit from the City/County Building Department. A fence constructed on a corner lot that extends past the rear of the house along the side yard or abuts an alley requires approval from the City Engineer (Section 4.1.J of the Grand Junction Zoning and Development Code).

The owner/applicant must correctly identify all property lines, easements, and rights-of-way and ensure the fence is located within the property's boundaries. Covenants, conditions, restrictions, easements and/or rights-of-way may restrict or prohibit the placement of fence(s). The owner/applicant is responsible for compliance with covenants, conditions, and restrictions which may apply. Fences built in easements may be subject to removal at the property owner's sole and absolute expense. Any modification of design and/or material as approved in this fence permit must be approved, in writing, by the Community Development Department Director.

I hereby acknowledge that I have read this application and the information and plot plan are correct; I agree to comply with any and all codes, ordinances, laws, regulations, or restrictions which apply. I understand that failure to comply shall result in legal action, which may include but not necessarily be limited to removal of the fence(s) at the owner's cost.

Applicant's Signature: Donna M Mathieu Date: 10-29-04
Community Development's Approval: Dayleen Henderson Date: 10-29-04
City Engineer's Approval (if required) Date:

VALID FOR SIX MONTHS FROM DATE OF ISSUANCE (Section 2.2.E.1.d Grand Junction Zoning & Development Code)
(White: Planning) (Yellow: Customer) (Pink: Code Enforcement)

WORK ORDER

TAYLOR FENCE COMPANY

TO Mr + Mrs Ashbeck
339 Redcliff Church Ct
GJ Co 81503

DATE 10-22 20 04 **W** 6858

PHONE 244-1437 work
 CUSTOMER'S ORDER NO. _____

TERMS _____ SALESMAN Jerry O

QUANTITY	DESCRIPTION	PRICE
24	1x6x4 Cedar Fence use 1x6x6 Set 4 Nail	
5	4x4x8 Cedar post NO pickets	
8-	2x4x8 Cedar Rails 2 Rails per section Locktuff	
1-	10' Removal section Ring Shank galv nails	

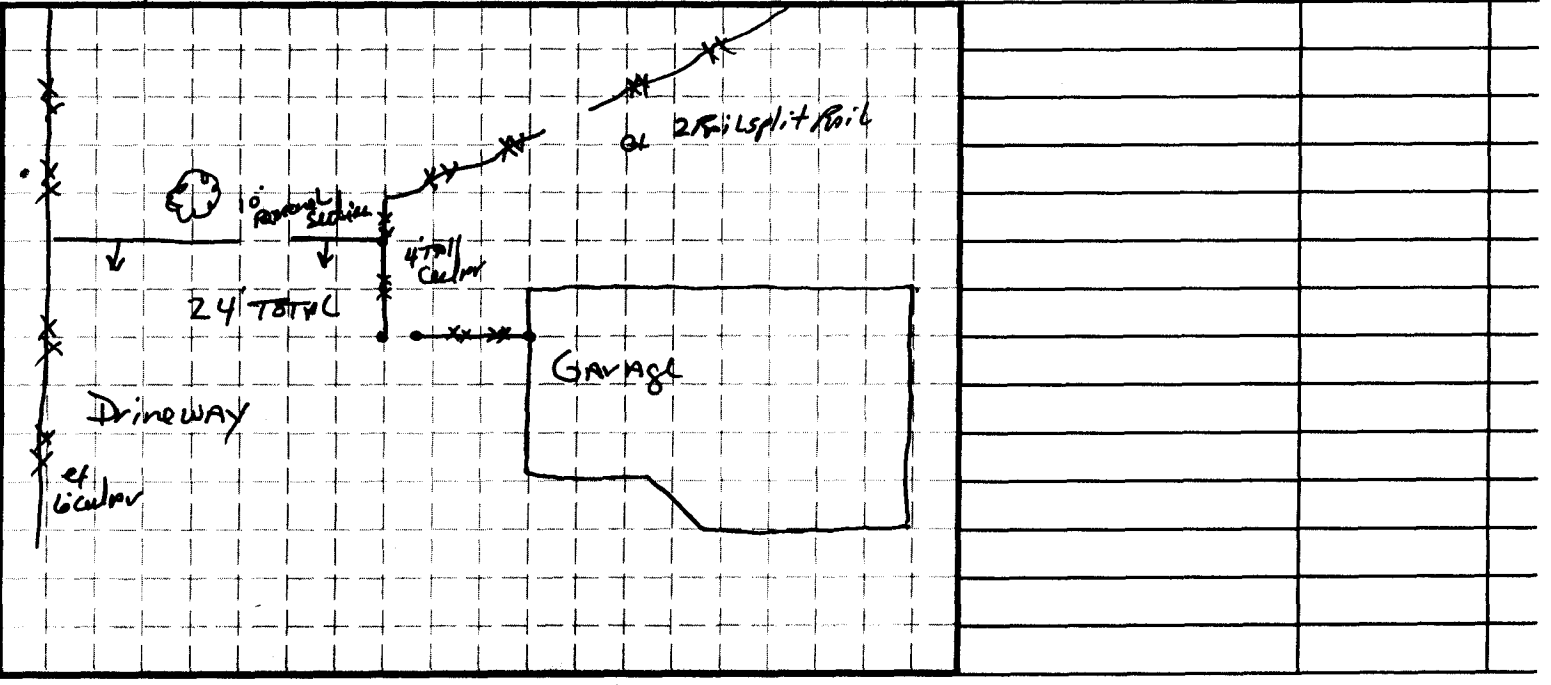

Map1



SCALE 1 : 369

