

FEE \$10.00

PERMIT # 12991



FENCE PERMIT
GRAND JUNCTION COMMUNITY DEVELOPMENT DEPARTMENT

THIS SECTION TO BE COMPLETED BY APPLICANT

PROPERTY ADDRESS: 1410 North Ave
PROPERTY TAX NO: 2945-123-21-015
SUBDIVISION:
PROPERTY OWNER: Rent To Own
OWNER'S PHONE: 245-7368
OWNER'S ADDRESS:
CONTRACTOR NAME: Taylor Fence
CONTRACTOR'S PHONE: 241-1473
CONTRACTOR'S ADDRESS: 832 2112 Rd
FENCE MATERIAL & HEIGHT: 6" Cedar
PLOT PLAN
See Attached
Plot plan must show property lines and property dimensions, all easements, all rights-of-way, all structures, all setbacks from property lines, & fence height(s). NOTE: PROPERTY LINE IS LIKELY ONE FOOT OR MORE BEHIND THE SIDEWALK.

THIS SECTION TO BE COMPLETED BY COMMUNITY DEVELOPMENT DEPARTMENT STAFF

ZONE C-1
SETBACKS: Front 0' from property line (PL) or
SPECIAL CONDITIONS
from center of ROW, whichever is greater.
Side 0' from PL Rear 0' from PL

Fences exceeding six feet in height require a separate permit from the City/County Building Department. A fence constructed on a corner lot that extends past the rear of the house along the side yard or abuts an alley requires approval from the City Engineer (Section 4.1.J of the Grand Junction Zoning and Development Code).

The owner/applicant must correctly identify all property lines, easements, and rights-of-way and ensure the fence is located within the property's boundaries. Covenants, conditions, restrictions, easements and/or rights-of-way may restrict or prohibit the placement of fence(s). The owner/applicant is responsible for compliance with covenants, conditions, and restrictions which may apply. Fences built in easements may be subject to removal at the property owner's sole and absolute expense. Any modification of design and/or material as approved in this fence permit must be approved, in writing, by the Community Development Department Director.

I hereby acknowledge that I have read this application and the information and plot plan are correct; I agree to comply with any and all codes, ordinances, laws, regulations, or restrictions which apply. I understand that failure to comply shall result in legal action, which may include but not necessarily be limited to removal of the fence(s) at the owner's cost.

Applicant's Signature Donna M Matheny Date 7-1-04
Community Development's Approval Ronnie Edwards Date 7/1/04
City Engineer's Approval (if required) N/A Date

VALID FOR SIX MONTHS FROM DATE OF ISSUANCE (Section 2.2.E.1.d Grand Junction Zoning & Development Code)
(White: Planning) (Yellow: Customer) (Pink: Code Enforcement)

Need Fence permit Locate TOTAL Property

WORK ORDER

TAYLOR FENCE COMPANY

TO Rent to Own Rental Mart
1410 North Ave
GT 60 81501 Attn Earl Ritter

DATE 6-29 2004 **W** 6829

PHONE 245-7368

CUSTOMER'S ORDER NO. _____

TERMS _____ SALESMAN Jerry D

QUANTITY	DESCRIPTION	PRICE
98'	1x6x6 no/clar Cedar 200pc	
14	2 3/8 x 8' ss40 pipe post /conelines	Set n nail
44	2 3/8 metal to wood Brackets	Lock #
39	2x4x8 Cedar Rails 3 Rails per section	377788

Notes

Keep The Fence Straight on Top
Face The pickets in Toward Rent to Own

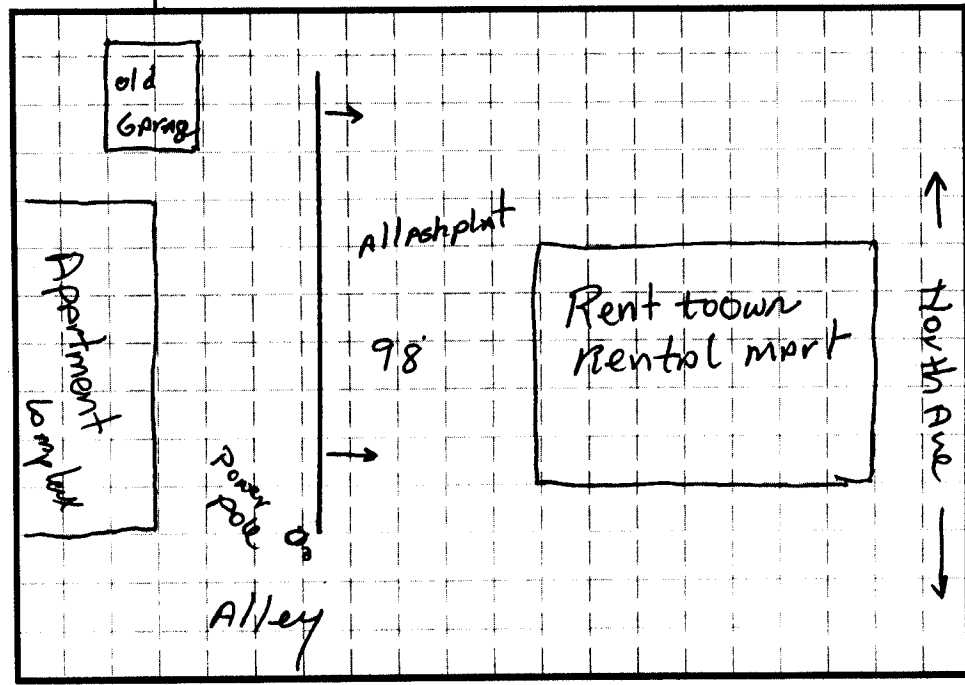

Johnson House
at E. ...