

FEE \$10.00

PERMIT # 12990



FENCE PERMIT
GRAND JUNCTION COMMUNITY DEVELOPMENT DEPARTMENT

THIS SECTION TO BE COMPLETED BY APPLICANT

PROPERTY ADDRESS: 2523 Patterson Rd
PROPERTY TAX NO: 2945-102-13-942
SUBDIVISION:
PROPERTY OWNER: Mesa City School
OWNER'S PHONE: 254-5201
OWNER'S ADDRESS:
CONTRACTOR NAME: Taylor Fence Co
CONTRACTOR'S PHONE: 241-1473
CONTRACTOR'S ADDRESS: 832 2 1/2 Rd
FENCE MATERIAL & HEIGHT: PVC 36"
PLOT PLAN: See Attached
Plot plan must show property lines and property dimensions, all easements, all rights-of-way, all structures, all setbacks from property lines, & fence height(s). NOTE: PROPERTY LINE IS LIKELY ONE FOOT OR MORE BEHIND THE SIDEWALK.

THIS SECTION TO BE COMPLETED BY COMMUNITY DEVELOPMENT DEPARTMENT STAFF

ZONE C-1
SPECIAL CONDITIONS 2 Rail
SETBACKS: Front 0' from property line (PL) or
Side 0' from PL Rear 0' from PL
from center of ROW, whichever is greater.

Fences exceeding six feet in height require a separate permit from the City/County Building Department. A fence constructed on a corner lot that extends past the rear of the house along the side yard or abuts an alley requires approval from the City Engineer (Section 4.1.J of the Grand Junction Zoning and Development Code).

The owner/applicant must correctly identify all property lines, easements, and rights-of-way and ensure the fence is located within the property's boundaries. Covenants, conditions, restrictions, easements and/or rights-of-way may restrict or prohibit the placement of fence(s). The owner/applicant is responsible for compliance with covenants, conditions, and restrictions which may apply. Fences built in easements may be subject to removal at the property owner's sole and absolute expense. Any modification of design and/or material as approved in this fence permit must be approved, in writing, by the Community Development Department Director.

I hereby acknowledge that I have read this application and the information and plot plan are correct; I agree to comply with any and all codes, ordinances, laws, regulations, or restrictions which apply. I understand that failure to comply shall result in legal action, which may include but not necessarily be limited to removal of the fence(s) at the owner's cost.

Applicant's Signature Donna M Mathieu Date 7-1-04
Community Development's Approval Ronnie Edwards Date 7/1/04
City Engineer's Approval (if required) N/A Date

VALID FOR SIX MONTHS FROM DATE OF ISSUANCE (Section 2.2.E.1.d Grand Junction Zoning & Development Code)
(White: Planning) (Yellow: Customer) (Pink: Code Enforcement)

Locate TOTAL Job

Need Fence permit

WORK ORDER

# TAYLOR FENCE COMPANY

TO Mesa County School Dist 51

DATE 6-21 20 04 W 6826

PHONE 254-5201

ATTN Earl

CUSTOMER'S ORDER NO.

TERMS Job BASIL Knight Center

SALESMAN Jerry O

QUANTITY	DESCRIPTION	PRICE
336	1 1/2 x 5 1/2 2 Rail white PVC Fence	
42	1 1/2 x 5 1/2 x 16 Rails	
41	5" x 5" x 5'6" 2 Rail Lines	317782
6	5" x 5" x 5'6" 2 Rail Ends	
1	5" x 5" x 5'6" 2 Rail Corners	
	5" Flat Caps	

Install New 2 Rail PVC Fence in The Front of the Building  
 Take Small Drandy Digger

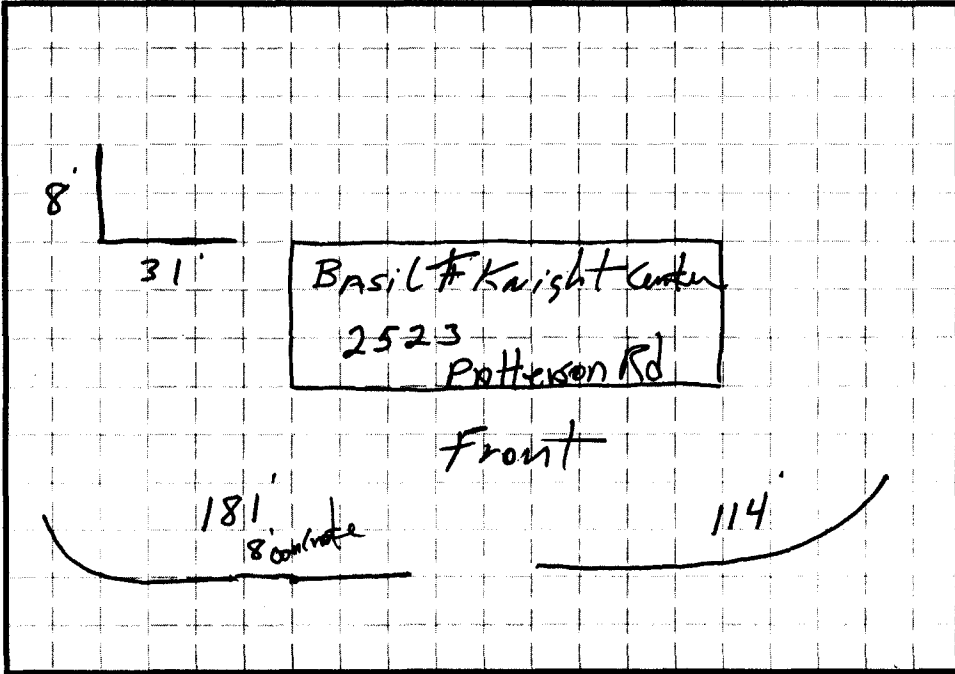

\*Lums Lights

BH Sports