

FEE \$10.00

PERMIT # 13424

FENCE PERMIT
GRAND JUNCTION COMMUNITY DEVELOPMENT DEPARTMENT

Property Address: 2531-B West Pinyon Av.
Property Tax No: 2945-102-41-002
Subdivision:
Property Owner: James Tarr
Owner's Telephone: 242-5367
Owner's Address: 2531-A West Pinyon Av.
Contractor's Name: Brad Pollard
Contractor's Telephone: ~~260-4295~~ 260-3453
Contractor's Address: 412 Stoneridge Ct.
Fence Material & Height: 4 ft. High Chain link

Plot plan must show property lines and property dimensions, all easements, all rights-of-way, all structures, all setbacks from property lines, and fence height(s). NOTE: Property line is likely one foot or more behind the sidewalk.

THIS SECTION TO BE COMPLETED BY COMMUNITY DEVELOPMENT DEPARTMENT STAFF

ZONE C-2 SETBACKS: Front 15' from property line (PL) or
SPECIAL CONDITIONS _____ from center of ROW, whichever is greater.
Side 0' from PL Rear 10' from PL

Fences exceeding six feet in height require a separate permit from the City/County Building Department. A fence constructed on a corner lot that extends past the rear of the house along the side yard or abuts an alley requires approval from the City Engineer (Section 4.1.J of the Grand Junction Zoning and Development Code).

The owner/applicant must correctly identify all property lines, easements, and rights-of-way and ensure the fence is located within the property's boundaries. Covenants, conditions, restrictions, easements and/or rights-of-way may restrict or prohibit the placement of fence(s). The owner/applicant is responsible for compliance with covenants, conditions, and restrictions which may apply. Fences built in easements may be subject to removal at the property owner's sole and absolute expense. Any modification of design and/or material as approved in this fence permit must be approved, in writing, by the Community Development Department Director.

I hereby acknowledge that I have read this application and the information and plot plan are correct; I agree to comply with any and all codes, ordinances, laws, regulations, or restrictions which apply. I understand that failure to comply shall result in legal action, which may include but not necessarily be limited to removal of the fence(s) at the owner's cost.

Applicant's Signature Nancy Pollard Date 12-10-04
Community Development's Approval Mrs. Wagon Date 12/10/04
City Engineer's Approval (if required) _____ Date _____

VALID FOR SIX MONTHS FROM DATE OF ISSUANCE (Section 2.2.E.1.d Grand Junction Zoning & Development Code)

(White: Planning) (Yellow: Customer) (Pink: Code Enforcement)

EXHIBIT

B

WEST PINYON AVENUE

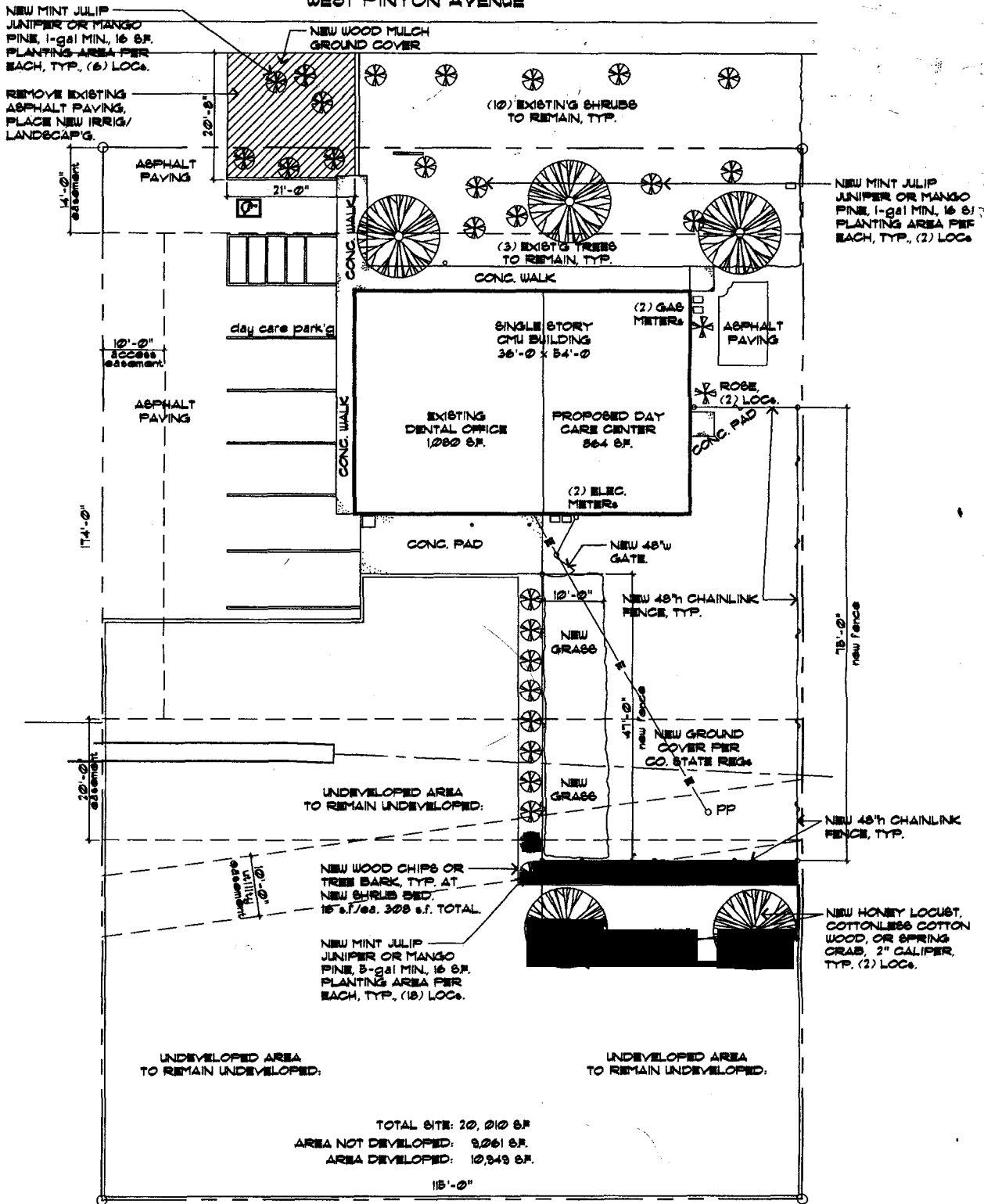

SITE DEVELOPEMENT PLAN

1/16" = 1'-0"

plan update: 25 oct 04

