

FEE \$10.00

PERMIT #

12088



FENCE PERMIT
GRAND JUNCTION COMMUNITY DEVELOPMENT DEPARTMENT

THIS SECTION TO BE COMPLETED BY APPLICANT

PROPERTY ADDRESS: 519 North 18th St
PROPERTY TAX NO: 2945-132-14-942
SUBDIVISION:
PROPERTY OWNER: Mesa City School
OWNER'S PHONE: 281-5201
OWNER'S ADDRESS:
CONTRACTOR NAME: Taylor Fence Co
CONTRACTOR'S PHONE: 241-1473
CONTRACTOR'S ADDRESS: 832 2 1/2 Rd
FENCE MATERIAL & HEIGHT: 48" c/w

PLOT PLAN

See Attached

Plot plan must show property lines and property dimensions, all easements, all rights-of-way, all structures, all setbacks from property lines, & fence height(s). NOTE: PROPERTY LINE IS LIKELY ONE FOOT OR MORE BEHIND THE SIDEWALK.

THIS SECTION TO BE COMPLETED BY COMMUNITY DEVELOPMENT DEPARTMENT STAFF

ZONE BMTF-8
SETBACKS: Front 0' from property line (PL) or
SPECIAL CONDITIONS
Side 0' from PL Rear 0' from PL

Fences exceeding six feet in height require a separate permit from the City/County Building Department. A fence constructed on a corner lot that extends past the rear of the house along the side yard or abuts an alley requires approval from the City Engineer (Section 4.1.J of the Grand Junction Zoning and Development Code).

The owner/applicant must correctly identify all property lines, easements, and rights-of-way and ensure the fence is located within the property's boundaries. Covenants, conditions, restrictions, easements and/or rights-of-way may restrict or prohibit the placement of fence(s). The owner/applicant is responsible for compliance with covenants, conditions, and restrictions which may apply. Fences built in easements may be subject to removal at the property owner's sole and absolute expense. Any modification of design and/or material as approved in this fence permit must be approved, in writing, by the Community Development Department Director.

I hereby acknowledge that I have read this application and the information and plot plan are correct; I agree to comply with any and all codes, ordinances, laws, regulations, or restrictions which apply. I understand that failure to comply shall result in legal action, which may include but not necessarily be limited to removal of the fence(s) at the owner's cost.

Applicant's Signature Dana M Mathew
Community Development's Approval C Jay Hall
City Engineer's Approval (if required)

Date 7-1-04
Date 7/1/04
Date

VALID FOR SIX MONTHS FROM DATE OF ISSUANCE (Section 2.2.E.1.d Grand Junction Zoning & Development Code)
(White: Planning) (Yellow: Customer) (Pink: Code Enforcement)

Locate North side of School
Back to Front

WORK ORDER

TAYLOR FENCE COMPANY

TO Mesa County School Dist

DATE 6-9 2004 **W** 6706

PHONE _____
CUSTOMER'S ORDER NO. _____

SALESMAN Jerry O

*TERMS Jobsite 18th Street Cottage Att Encl

QUANTITY	DESCRIPTION	PRICE
57'	1 Roll + 10' 4 8" x 11 1/2 Chainlink complete	
57'	3 pcs 1 3/8 x 21' 0.55 Tube top rail	
5	1 5/8 x 5' 6" Tube line post	Set w/ steel h
5	1 5/8 x 1 3/8 Eye Tops	
60	Tiewines	Locate # 377744
1	2 3/8 x 6' Tube End Complete	
1	1 7/8 x 48" End Ticon	

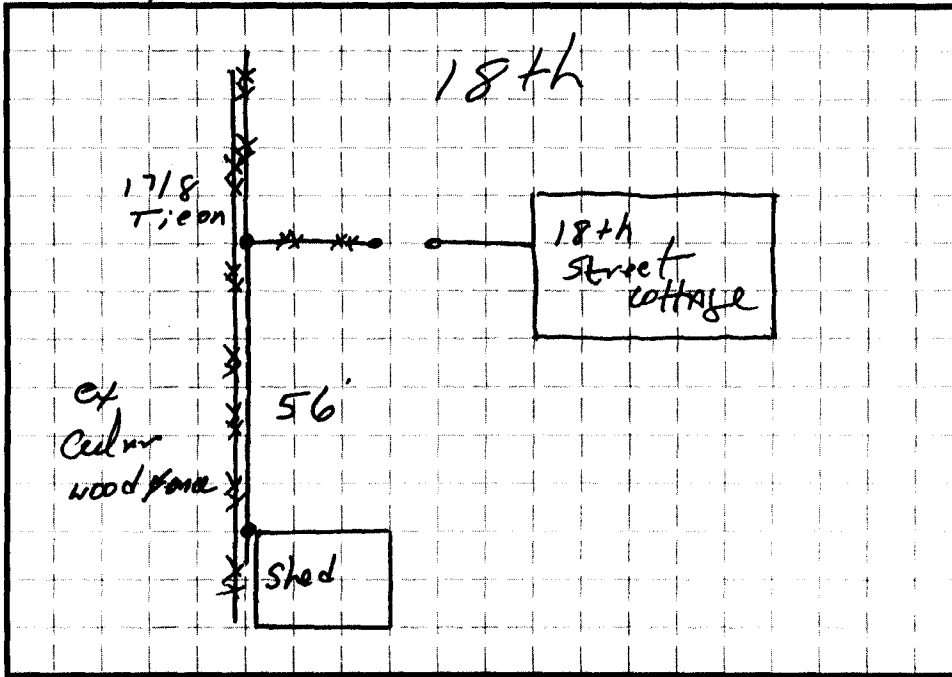

Alley