

FEE \$10.00

PERMIT #



FENCE PERMIT

GRAND JUNCTION COMMUNITY DEVELOPMENT DEPARTMENT

Property Address: 3344 Northridge Drive
 Property Tax No: 2945-023-18-014
 Subdivision: Northridge Estates Filing No 3
 Property Owner: Mark Achen
 Owner's Telephone: 241-9427
 Owner's Address: 3344 Northridge Dr
 Contractor's Name: Taylor Fence Co
 Contractor's Telephone: 241-1473
 Contractor's Address: 832 2 1/2 Road
 Fence Material & Height: 6' Cedar

Plot plan must show property lines and property dimensions, all easements, all rights-of-way, all structures, all setbacks from property lines, and fence height(s). NOTE: Property line is likely one foot or more behind the sidewalk.

THIS SECTION TO BE COMPLETED BY COMMUNITY DEVELOPMENT DEPARTMENT STAFF

ZONE RSF-4 SETBACKS: Front _____ from property line (PL) or
 SPECIAL CONDITIONS _____ from center of ROW, whichever is greater.
 _____ Side _____ from PL Rear _____ from PL

Fences exceeding six feet in height require a separate permit from the City/County Building Department. A fence constructed on a corner lot that extends past the rear of the house along the side yard or abuts an alley requires approval from the City Engineer (Section 4.1.J of the Grand Junction Zoning and Development Code).

The owner/applicant must correctly identify all property lines, easements, and rights-of-way and ensure the fence is located within the property's boundaries. Covenants, conditions, restrictions, easements and/or rights-of-way may restrict or prohibit the placement of fence(s). The owner/applicant is responsible for compliance with covenants, conditions, and restrictions which may apply. Fences built in easements may be subject to removal at the property owner's sole and absolute expense. Any modification of design and/or material as approved in this fence permit must be approved, in writing, by the Community Development Department Director.

I hereby acknowledge that I have read this application and the information and plot plan are correct; I agree to comply with any and all codes, ordinances, laws, regulations, or restrictions which apply. I understand that failure to comply shall result in legal action, which may include but not necessarily be limited to removal of the fence(s) at the owner's cost.

Applicant's Signature Donna Mathieu Date 11-9-04
 Community Development's Approval Gayleen Henderson Date 11-9-04
 City Engineer's Approval (if required) _____ Date _____

VALID FOR SIX MONTHS FROM DATE OF ISSUANCE (Section 2.2.E.1.d Grand Junction Zoning & Development Code)

(White: Planning)

(Yellow: Customer)

(Pink: Code Enforcement)

WORK ORDER
TAYLOR FENCE COMPANY

TO Mr Mark Achen
3344 Northridge Drive
GJ Co 81506 off 1st Street

DATE 10-25 20 04 **W** 6859
 PHONE 241-9427
 CUSTOMER'S ORDER NO. _____
 SALESMAN Terry O

QUANTITY	DESCRIPTION	PRICE
66'	1x6x6 No1 clear Cedar Fence 132 pcs Set N NAIL	
10	4x4x8' Cedar post	
27	2x4x8 Cedar Rails Locatett	1643030
9 extra	2x4x8 Cedar Rails Nailed to The Inside Bottom of the Fence	
	Ring Shank galv Nails	
	Concrete	
	Fence Removal + HAUL off of ex Fence	
	FACE The pickets Inward	
	MATCH The Height of The ex Fence	

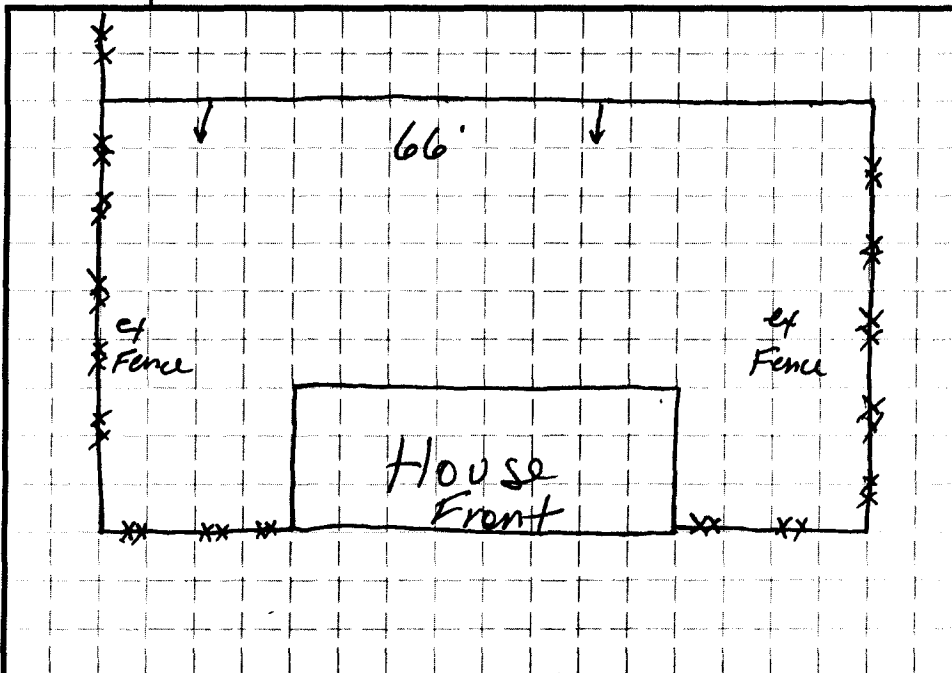

City of Grand Junction GIS Zoning Map ©



SCALE 1 : 285



2945-023-18-014