

FEE \$10.00

PERMIT # 14732

FENCE PERMIT
GRAND JUNCTION COMMUNITY DEVELOPMENT DEPARTMENT

Property Address: 2497 Interlochen Ct.
Property Tax No: 2701-334-31-005
Subdivision: Fountain Greens
Property Owner: Dale & Joan Clarke
Owner's Telephone: (970) 245-8781
Owner's Address: 2497 Interlochen Ct.
Contractor's Name: J & S Fence Company, Inc.
Contractor's Telephone: (970) 243-2723
Contractor's Address: 2886 I-70 Business Loop, Grand Jct. CO 81501
Fence Material & Height: 4' high, PVC, Picket

Plot plan must show property lines and property dimensions, all easements, all rights-of-way, all structures, all setbacks from property lines, and fence height(s). NOTE: Property line is likely one foot or more behind the sidewalk.

THIS SECTION TO BE COMPLETED BY COMMUNITY DEVELOPMENT DEPARTMENT STAFF

ZONE PD SETBACKS: Front 10' from property line (PL) or
SPECIAL CONDITIONS No restrictions along the back from center of ROW, whichever is greater.
Side from PL Rear from PL

Fences exceeding six feet in height require a separate permit from the City/County Building Department. A fence constructed on a corner lot that extends past the rear of the house along the side yard or abuts an alley requires approval from the City Engineer (Section 4.1.J of the Grand Junction Zoning and Development Code).

The owner/applicant must correctly identify all property lines, easements, and rights-of-way and ensure the fence is located within the property's boundaries. Covenants, conditions, restrictions, easements and/or rights-of-way may restrict or prohibit the placement of fence(s). The owner/applicant is responsible for compliance with covenants, conditions, and restrictions which may apply. Fences built in easements may be subject to removal at the property owner's sole and absolute expense. Any modification of design and/or material as approved in this fence permit must be approved, in writing, by the Community Development Department Director.

I hereby acknowledge that I have read this application and the information and plot plan are correct; I agree to comply with any and all codes, ordinances, laws, regulations, or restrictions which apply. I understand that failure to comply shall result in legal action, which may include but not necessarily be limited to removal of the fence(s) at the owner's cost.

Applicant's Signature Eric Downey Date 11/22/05
Community Development's Approval Kathy Valdez Date 11-22-05
City Engineer's Approval (if required) Date

VALID FOR SIX MONTHS FROM DATE OF ISSUANCE (Section 2.2.E.1.d Grand Junction Zoning & Development Code)

(White: Planning)

(Yellow: Customer)

(Pink: Code Enforcement)

INTERLOCHEN CT.

DRIVEWAY



NOTE: DRAWING IS NOT TO SCALE.  
■ — 4' HIGH, PVC PICKET

HOUSE



# City of Grand Junction GIS City Map ©

## Parcels

□ Address Label

## Air Photos

■ 2002 Photos

— Highways

— Street Labels

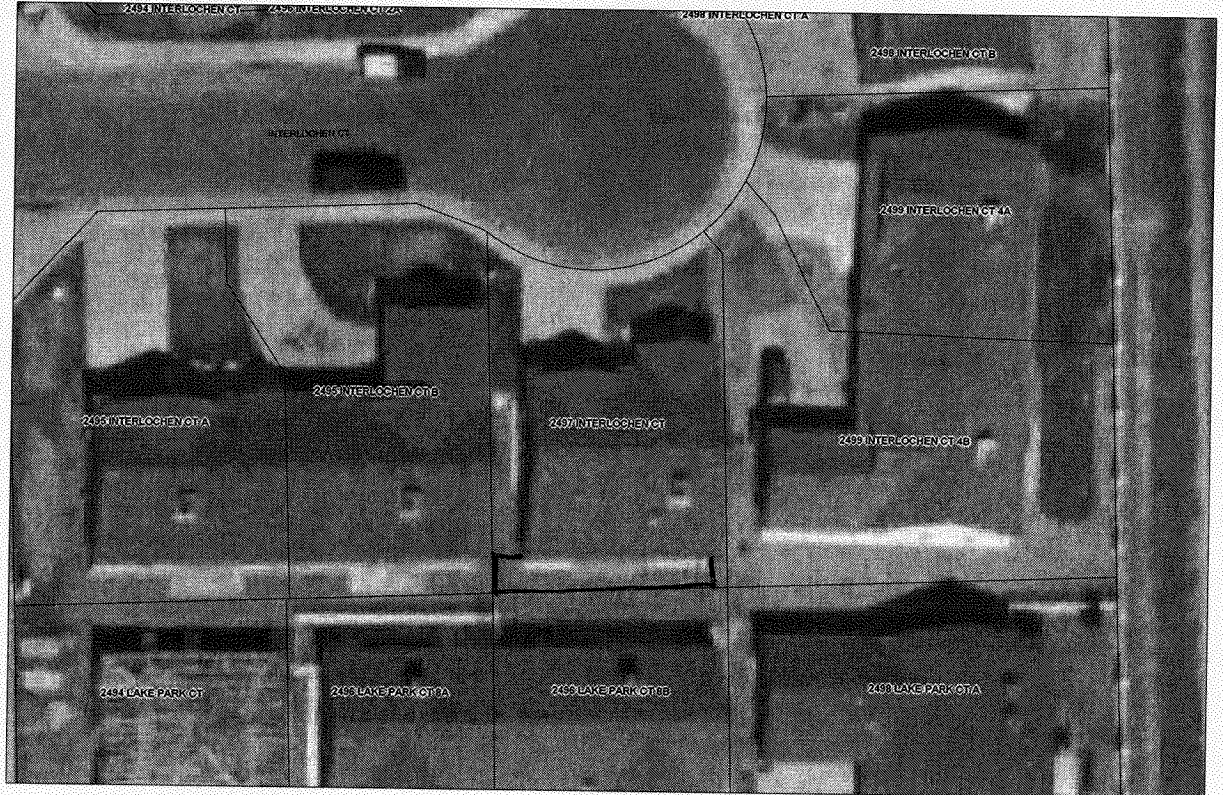

SCALE 1 : 513

