

FEE \$10.00

PERMIT # 13865

FENCE PERMIT
GRAND JUNCTION COMMUNITY DEVELOPMENT DEPARTMENT

Property Address: 728 CENTAURI CT
Property Tax No: 2701-354-67-002
Subdivision: WINDEMIERE HGTS
Property Owner: ANDREW & DIANNE HUTMACHER
Owner's Telephone: 970-245-9119
Owner's Address: SAME
Contractor's Name: STEVE STREMMEL
Contractor's Telephone:
Contractor's Address:
Fence Material & Height: VINYL (TAN) 6' OR LESS

Plot plan must show property lines and property dimensions, all easements, all rights-of-way, all structures, all setbacks from property lines, and fence height(s). NOTE: Property line is likely one foot or more behind the sidewalk.

THIS SECTION TO BE COMPLETED BY COMMUNITY DEVELOPMENT DEPARTMENT STAFF
ZONE RSF-2
SETBACKS: Front 20' from property line (PL) or
SPECIAL CONDITIONS
Side 0' from PL Rear 0' from PL

Fences exceeding six feet in height require a separate permit from the City/County Building Department. A fence constructed on a corner lot that extends past the rear of the house along the side yard or abuts an alley requires approval from the City Engineer (Section 4.1.J of the Grand Junction Zoning and Development Code).

The owner/applicant must correctly identify all property lines, easements, and rights-of-way and ensure the fence is located within the property's boundaries. Covenants, conditions, restrictions, easements and/or rights-of-way may restrict or prohibit the placement of fence(s). The owner/applicant is responsible for compliance with covenants, conditions, and restrictions which may apply. Fences built in easements may be subject to removal at the property owner's sole and absolute expense. Any modification of design and/or material as approved in this fence permit must be approved, in writing, by the Community Development Department Director.

I hereby acknowledge that I have read this application and the information and plot plan are correct; I agree to comply with any and all codes, ordinances, laws, regulations, or restrictions which apply. I understand that failure to comply shall result in legal action, which may include but not necessarily be limited to removal of the fence(s) at the owner's cost.

Applicant's Signature [Signature] Date
Community Development's Approval [Signature] Date 7/26/15
City Engineer's Approval (if required) Date

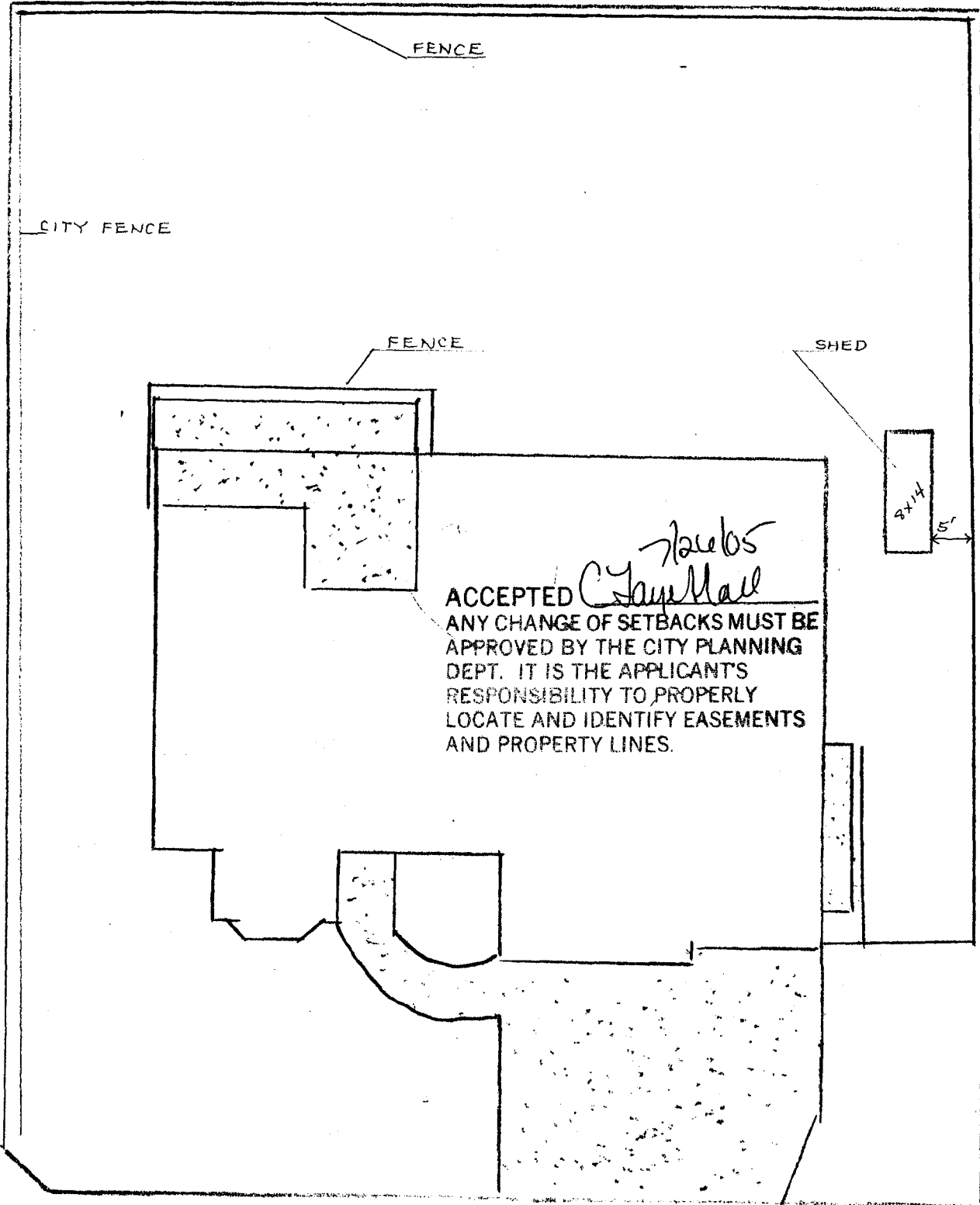

FENCE

CITY FENCE

FENCE

SHED

8x14

5'

ACCEPTED *Jacob's*  
*C. J. Hall*  
ANY CHANGE OF SETBACKS MUST BE  
APPROVED BY THE CITY PLANNING  
DEPT. IT IS THE APPLICANT'S  
RESPONSIBILITY TO PROPERLY  
LOCATE AND IDENTIFY EASEMENTS  
AND PROPERTY LINES.

HUTMACHER RESIDENCE  
728 CENTAURI CT  
GR JCT CO 81506