

FEE \$10.00

PERMIT # 14118

FENCE PERMIT
GRAND JUNCTION COMMUNITY DEVELOPMENT DEPARTMENT

Property Address: 244 Pitkin Ave

Property Tax No: 2945-143-35-017

Subdivision: NO

Property Owner: Thomas Spiegelberg

Owner's Telephone: 254-8939

Owner's Address: 630 Oxbow Rd Grand Jct CO 81504

Contractor's Name: Victor + Juanita Munoz

Contractor's Telephone: 263-8324 cell 208-4795

Contractor's Address: 244 Pitkin Ave G.Jct CO. ("mail" P.O. Box 1003 G.Jct CO 81502

Fence Material & Height: 6 feet tall.

Plot plan must show property lines and property dimensions, all easements, all rights-of-way, all structures, all setbacks from property lines, and fence height(s). NOTE: Property line is likely one foot or more behind the sidewalk.

THIS SECTION TO BE COMPLETED BY COMMUNITY DEVELOPMENT DEPARTMENT STAFF

Form with fields for ZONE (B-2), SPECIAL CONDITIONS, and SETBACKS (Front 15/25, Side 00, Rear 00).

Fences exceeding six feet in height require a separate permit from the City/County Building Department. A fence constructed on a corner lot that extends past the rear of the house along the side yard or abuts an alley requires approval from the City Engineer (Section 4.1.J of the Grand Junction Zoning and Development Code).

The owner/applicant must correctly identify all property lines, easements, and rights-of-way and ensure the fence is located within the property's boundaries. Covenants, conditions, restrictions, easements and/or rights-of-way may restrict or prohibit the placement of fence(s). The owner/applicant is responsible for compliance with covenants, conditions, and restrictions which may apply. Fences built in easements may be subject to removal at the property owner's sole and absolute expense. Any modification of design and/or material as approved in this fence permit must be approved, in writing, by the Community Development Department Director.

I hereby acknowledge that I have read this application and the information and plot plan are correct; I agree to comply with any and all codes, ordinances, laws, regulations, or restrictions which apply. I understand that failure to comply shall result in legal action, which may include but not necessarily be limited to removal of the fence(s) at the owner's cost.

Applicant's Signature: Juanita Munoz Date: 5-2-06
Community Development's Approval: Wendy Spurr Date: 5/2/06
City Engineer's Approval (if required): Date:

VALID FOR SIX MONTHS FROM DATE OF ISSUANCE (Section 2.2.E.1.d Grand Junction Zoning & Development Code)

(White: Planning) (Yellow: Customer) (Pink: Code Enforcement)

242
Pitkin



10' - 00"

244 Pitkin

Front Entrance
4 Foot Chain Link Fence

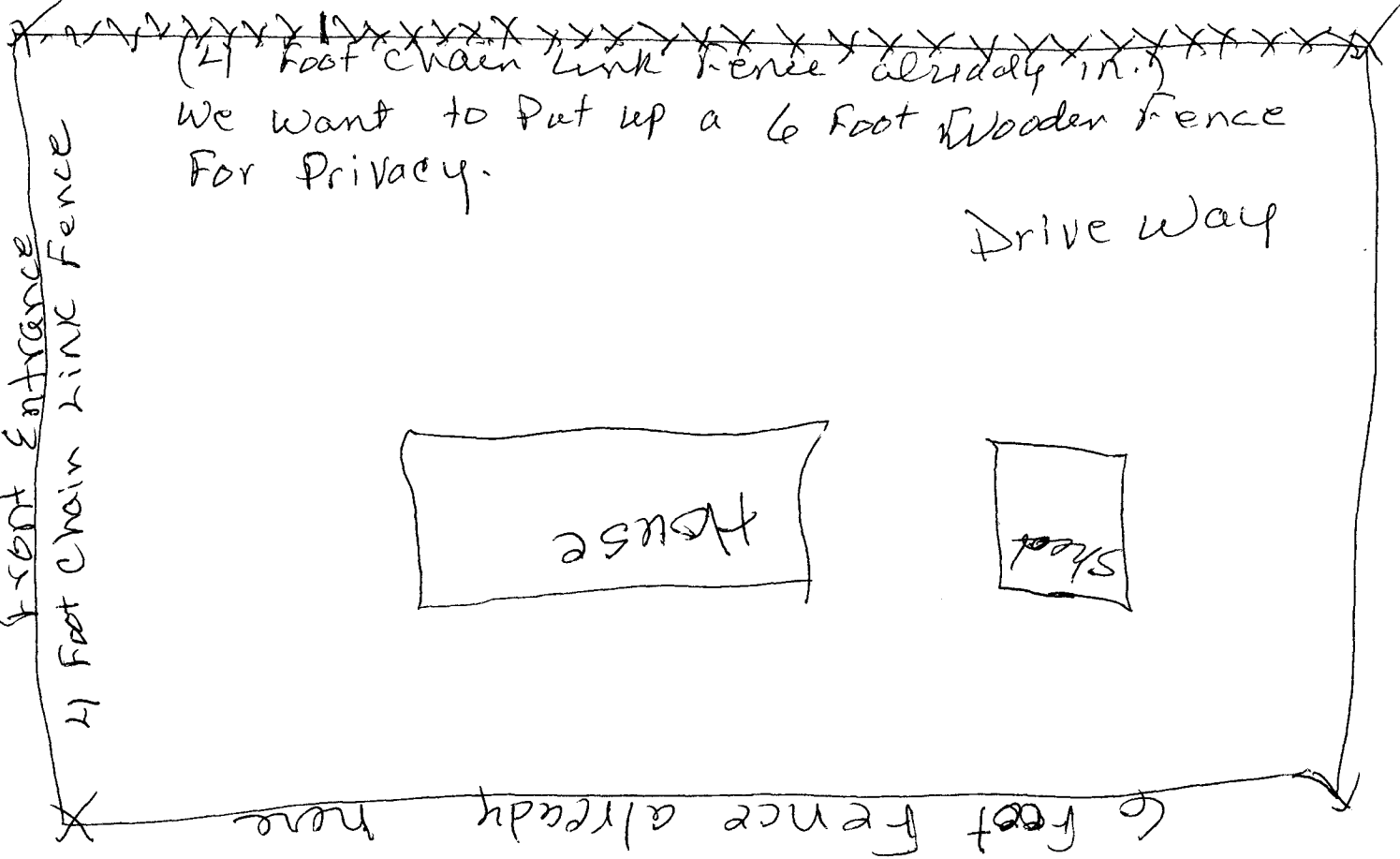

(4) foot Chain Link Fence already in.
We want to Put up a 6 Foot Wooden Fence
For Privacy.

Drive way

House

Shed

Alley

6 foot Fence already here