

FEE \$10.00

PERMIT # 14084

FENCE PERMIT
GRAND JUNCTION COMMUNITY DEVELOPMENT DEPARTMENT

Property Address: 247 Ophir Ct
Property Tax No: 2943-303-74-012
Subdivision: Durango Acres
Property Owner: Kathleen Hardy
Owner's Telephone: 243-1138
Owner's Address: Same
Contractor's Name: V.W.F
Contractor's Telephone: 243-1138
Contractor's Address: 2105 E main
Fence Material & Height: 6' vinyl

Plot plan must show property lines and property dimensions, all easements, all rights-of-way, all structures, all setbacks from property lines, and fence height(s). NOTE: Property line is likely one foot or more behind the sidewalk.

THIS SECTION TO BE COMPLETED BY COMMUNITY DEVELOPMENT DEPARTMENT STAFF
ZONE RSF-4
SPECIAL CONDITIONS none
SETBACKS: Front 20 from property line (PL) or from center of ROW, whichever is greater.
Side from PL Rear from PL

Fences exceeding six feet in height require a separate permit from the City/County Building Department. A fence constructed on a corner lot that extends past the rear of the house along the side yard or abuts an alley requires approval from the City Engineer (Section 4.1.J of the Grand Junction Zoning and Development Code).

The owner/applicant must correctly identify all property lines, easements, and rights-of-way and ensure the fence is located within the property's boundaries. Covenants, conditions, restrictions, easements and/or rights-of-way may restrict or prohibit the placement of fence(s). The owner/applicant is responsible for compliance with covenants, conditions, and restrictions which may apply. Fences built in easements may be subject to removal at the property owner's sole and absolute expense. Any modification of design and/or material as approved in this fence permit must be approved, in writing, by the Community Development Department Director.

I hereby acknowledge that I have read this application and the information and plot plan are correct; I agree to comply with any and all codes, ordinances, laws, regulations, or restrictions which apply. I understand that failure to comply shall result in legal action, which may include but not necessarily be limited to removal of the fence(s) at the owner's cost.

Applicant's Signature Cherynn D. Pallock Date 8-31-06
Community Development's Approval [Signature] Date 9/5/06
City Engineer's Approval (if required) Date

VALID FOR SIX MONTHS FROM DATE OF ISSUANCE (Section 2.2.E.1.d Grand Junction Zoning & Development Code)

(White: Planning) (Yellow: Customer) (Pink: Code Enforcement)

VALLEYWIDE FENCE

(970) 523-8150

Fax: (970) 523-5272

PO, Box 445
Clifton, CO 81520

2105 E. Main St. Grand Junction, CO 81501

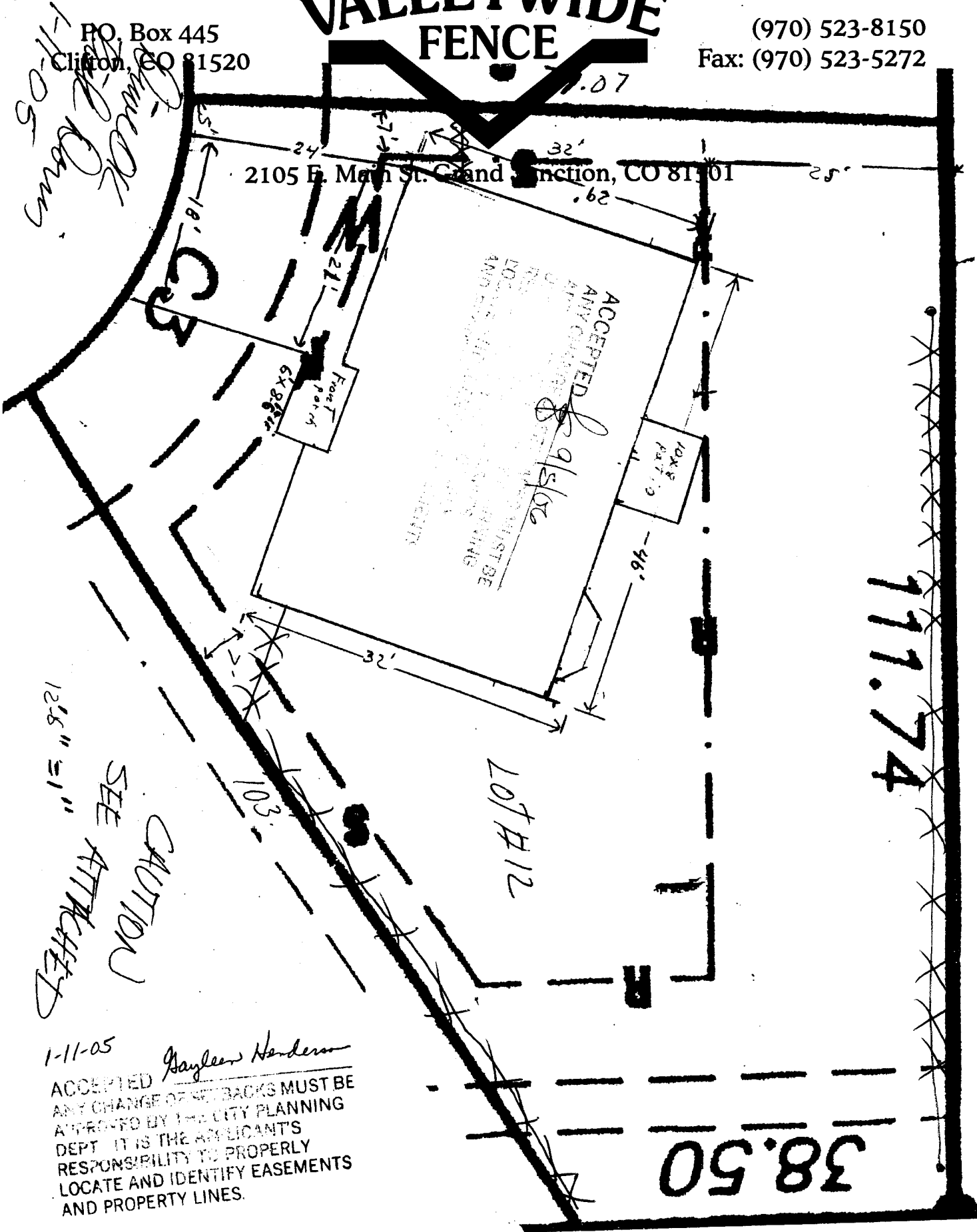

1-11-05
Handwritten notes and signatures in the top left corner.

ACCEPTED
ANY CHANGE OF SETBACKS MUST BE
APPROVED BY THE CITY PLANNING
DEPT. IT IS THE APPLICANT'S
RESPONSIBILITY TO PROPERLY
LOCATE AND IDENTIFY EASEMENTS
AND PROPERTY LINES.

12'8" = 1"
CAUTION
SEE ATTACHED

1-11-05
Gayle's Henderson
ACCEPTED
ANY CHANGE OF SETBACKS MUST BE
APPROVED BY THE CITY PLANNING
DEPT. IT IS THE APPLICANT'S
RESPONSIBILITY TO PROPERLY
LOCATE AND IDENTIFY EASEMENTS
AND PROPERTY LINES.

111.74

38.50