

FEE \$10.00

PERMIT # 14465

FENCE PERMIT
GRAND JUNCTION COMMUNITY DEVELOPMENT DEPARTMENT

Property Address: 2841 Kennedy Ave
Property Tax No: 2943-073-37-005
Subdivision: Camelot
Property Owner: John and Leslye James
Owner's Telephone: 255-8328
Owner's Address: 2841 Kennedy Ave
Contractor's Name: Self
Contractor's Telephone: 255-8328
Contractor's Address: 2841 Kennedy Ave
Fence Material & Height: Chain link 4 foot height

Plot plan must show property lines and property dimensions, all easements, all rights-of-way, all structures, all setbacks from property lines, and fence height(s). NOTE: Property line is likely one foot or more behind the sidewalk.

THIS SECTION TO BE COMPLETED BY COMMUNITY DEVELOPMENT DEPARTMENT STAFF
ZONE PD
SPECIAL CONDITIONS
SETBACKS: Front 20 PD from property line (PL) or
Side from PL Rear from PL

Fences exceeding six feet in height require a separate permit from the City/County Building Department. A fence constructed on a corner lot that extends past the rear of the house along the side yard or abuts an alley requires approval from the City Engineer (Section 4.1.J of the Grand Junction Zoning and Development Code).

The owner/applicant must correctly identify all property lines, easements, and rights-of-way and ensure the fence is located within the property's boundaries. Covenants, conditions, restrictions, easements and/or rights-of-way may restrict or prohibit the placement of fence(s). The owner/applicant is responsible for compliance with covenants, conditions, and restrictions which may apply. Fences built in easements may be subject to removal at the property owner's sole and absolute expense. Any modification of design and/or material as approved in this fence permit must be approved, in writing, by the Community Development Department Director.

I hereby acknowledge that I have read this application and the information and plot plan are correct; I agree to comply with any and all codes, ordinances, laws, regulations, or restrictions which apply. I understand that failure to comply shall result in legal action, which may include but not necessarily be limited to removal of the fence(s) at the owner's cost.

Applicant's Signature: Leslye James Date: Nov 17, 2006
Community Development's Approval: [Signature] Date: 11/17/06
City Engineer's Approval (if required): [Signature] Date:

VALID FOR SIX MONTHS FROM DATE OF ISSUANCE (Section 2.2.E.1.d Grand Junction Zoning & Development Code)
(White: Planning) (Yellow: Customer) (Pink: Code Enforcement)

1/4 cm = 2 feet

ACCEPTED  
APPROVED  
CORRECTED  
DATE  
BY  
LOCATION  
APP.

02/17/00  
[Signature]

PARENTS

Single dwelling home

B' Section  
←

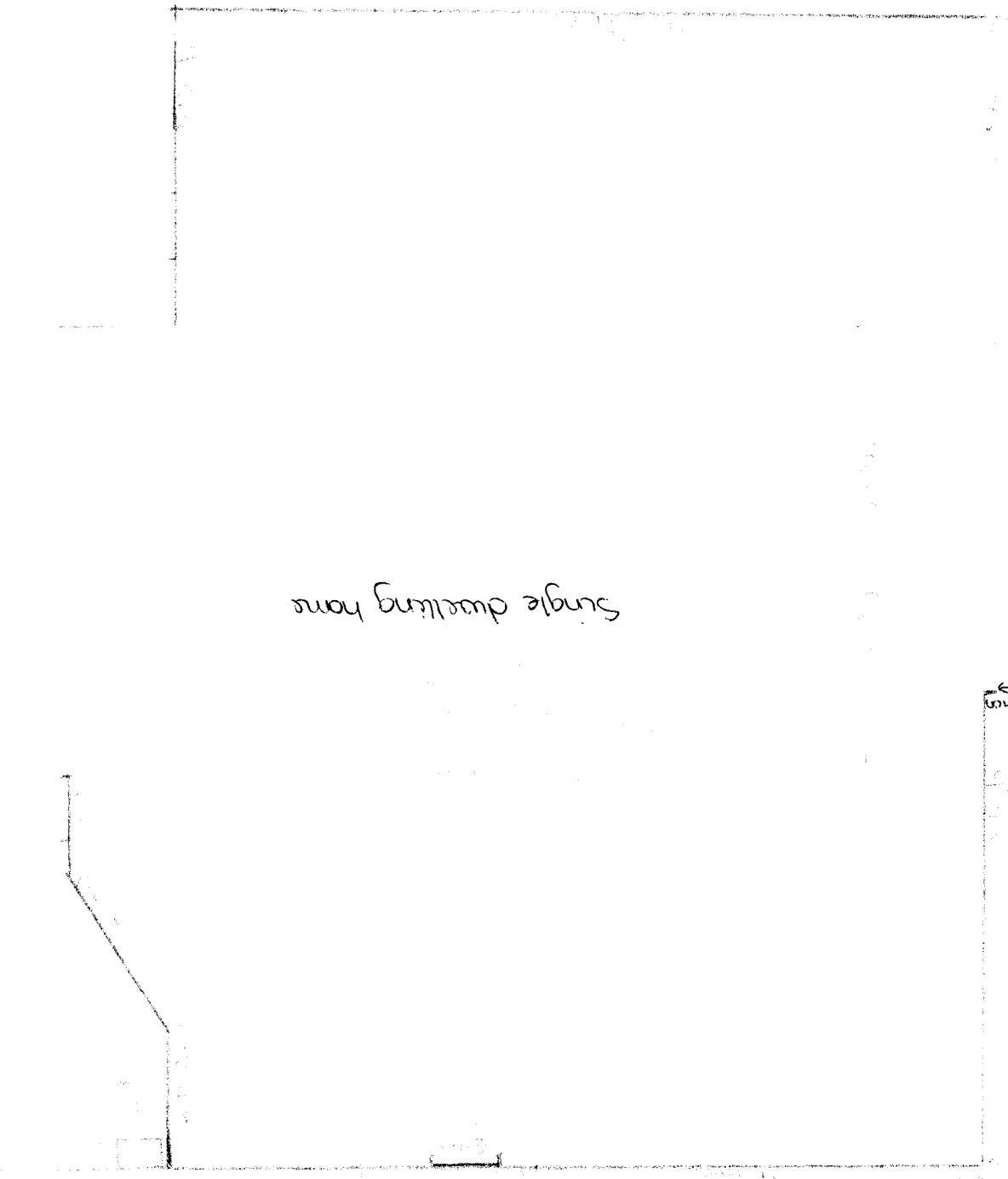

Measurements are close rough  
I understand them  
I understand them  
I understand them