

FEE \$10.00

PERMIT # 14248 *p*

FENCE PERMIT
GRAND JUNCTION COMMUNITY DEVELOPMENT DEPARTMENT

Property Address: 350 Canyon Rim Ct.
 Property Tax No: 2945-192-18-021
 Subdivision: Canyon Rimm
 Property Owner: Tom & Joan Kenyon
 Owner's Telephone: (970) 260-1537
 Owner's Address: 350 Canyon Rim Ct.
 Contractor's Name: J & S Fence Company, Inc.
 Contractor's Telephone: (970) 243-2723
 Contractor's Address: 2886 I-70 Bus. Loop, Grand Junction, CO 81501
 Fence Material & Height: 4' high, Solid Vertical, PVC

Plot plan must show property lines and property dimensions, all easements, all rights-of-way, all structures, all setbacks from property lines, and fence height(s). NOTE: Property line is likely one foot or more behind the sidewalk.

THIS SECTION TO BE COMPLETED BY COMMUNITY DEVELOPMENT DEPARTMENT STAFF	
ZONE <u>RSF-2</u>	SETBACKS: Front _____ from property line (PL) or
SPECIAL CONDITIONS _____	_____ from center of ROW, whichever is greater.
_____	Side _____ from PL Rear _____ from PL

Fences exceeding six feet in height require a separate permit from the City/County Building Department. A fence constructed on a corner lot that extends past the rear of the house along the side yard or abuts an alley requires approval from the City Engineer (Section 4.1.J of the Grand Junction Zoning and Development Code).

The owner/applicant must correctly identify all property lines, easements, and rights-of-way and ensure the fence is located within the property's boundaries. Covenants, conditions, restrictions, easements and/or rights-of-way may restrict or prohibit the placement of fence(s). The owner/applicant is responsible for compliance with covenants, conditions, and restrictions which may apply. Fences built in easements may be subject to removal at the property owner's sole and absolute expense. Any modification of design and/or material as approved in this fence permit must be approved, in writing, by the Community Development Department Director.

I hereby acknowledge that I have read this application and the information and plot plan are correct; I agree to comply with any and all codes, ordinances, laws, regulations, or restrictions which apply. I understand that failure to comply shall result in legal action, which may include but not necessarily be limited to removal of the fence(s) at the owner's cost.

Applicant's Signature Eric Downing Date 7/06/07
 Community Development's Approval Gayle Henderson Date 7-6-07
 City Engineer's Approval (if required) _____ Date _____

VALID FOR SIX MONTHS FROM DATE OF ISSUANCE (Section 2.2.E.1.d Grand Junction Zoning & Development Code)

(White: Planning)

(Yellow: Customer)

(Pink: Code Enforcement)

City of Grand Junction GIS City Map ©

Permit # 14248

Parcels

 Address Label

Air Photos

 2006 Photos

Highways

 Highways

Street Labels

 Street Labels

City Limits

 Grand Junction

 Fruita

 Palisade

 Mesa County



SCALE 1 : 596

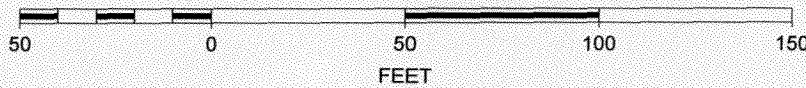

Permit # 14248

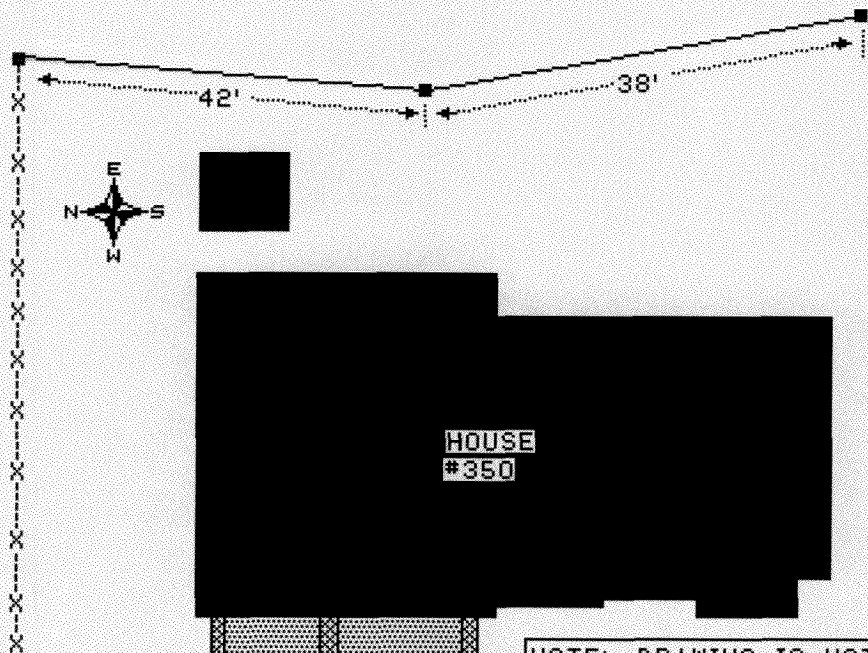

NOTE: DRAWING IS NOT TO SCALE.
■ — 4' HIGH, SANDSTONE, SOLID VERTICAL PVC FENCE.
--X-- EXISTING FENCE TO REMAIN.

CANYON RIM CT.