



Fence Permit

PERMIT # 14942

Community Development Department
250 North 5th Street
Grand Junction, CO 81501
Phone: (970) 244-1430 FAX (970) 236-4031

FEE \$10.00

Property Address: 401 W. Grand Ave

Property Tax No: 2945-154-11-010

Subdivision: Carpenters Sub F2

Property Owner: Cordeca, Frank

Owner's Telephone: 242-8032 Cell 816-2321

Owner's Address: 401 W. Grand Ave.

Contractor's Name: Cordeca, Frank

Contractor's Telephone: _____

Contractor's Address: _____

Fence Material & Height: 2 rail split rail - 4' tall

Plot plan must show property lines and property dimensions, all easements, all rights-of-way, all structures, all setbacks from property lines, and fence height(s). NOTE: Property line is likely one foot or more behind the sidewalk.

THIS SECTION TO BE COMPLETED BY COMMUNITY DEVELOPMENT DEPARTMENT STAFF

ZONE R-8 SETBACKS: Front _____ from property line (PL) or
 SPECIAL CONDITIONS _____ from center of ROW, whichever is greater.
 _____ Side _____ from PL Rear _____ from PL

Fences exceeding six feet in height require a separate permit from the City/County Building Department. A fence constructed on a corner lot that extends past the rear of the house along the side yard or abuts an alley requires approval from the City Engineer (Section 4.1.J of the Grand Junction Zoning and Development Code).

The owner/applicant must correctly identify all property lines, easements, and rights-of-way and ensure the fence is located within the property's boundaries. Covenants, conditions, restrictions, easements and/or rights-of-way may restrict or prohibit the placement of fence(s). The owner/applicant is responsible for compliance with covenants, conditions, and restrictions which may apply. Fences built in easements may be subject to removal at the property owner's sole and absolute expense. Any modification of design and/or material as approved in this fence permit must be approved, in writing, by the Community Development Department Director.

I hereby acknowledge that I have read this application and the information and plot plan are correct; I agree to comply with any and all codes, ordinances, laws, regulations, or restrictions which apply. I understand that failure to comply shall result in legal action, which may include but not necessarily be limited to removal of the fence(s) at the owner's cost.

Applicant's Signature Frank Cordeca Date 8-31-07

Community Development's Approval Gayleen Henderson Date 10-18-07

City Engineer's Approval (if required) _____ Date _____

VALID FOR SIX MONTHS FROM DATE OF ISSUANCE (Section 2.2.E.1.d Grand Junction Zoning & Development Code)

(White: Community Development) (Yellow: Applicant) (Pink: Code Enforcement)



ACCEPTED KL 7/11/89
ANY CHANGE OF SETBACKS MUST BE APPROVED BY THE CITY PLANNING DEPT. IT IS THE APPLICANT'S RESPONSIBILITY TO PROPERLY LOCATE AND IDENTIFY EASEMENTS AND PROPERTY LINES.

VINE ST.

26 FT.

West

Grand

26 FT.

Irrigation Ditch

X
X
X
X

Fence

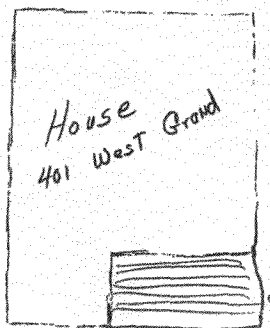

Property Line

20 FT.

water line 4' east

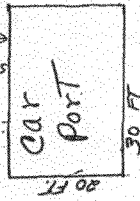

Patio shed



6" AC

Toe of slope

600' Road

Hwy 340