



# Fence Permit

PERMIT # 15330

Community Development Department  
250 North 5<sup>th</sup> Street  
Grand Junction, CO 81501  
Phone: (970) 244-1430 FAX (970) 236-4031

FEE \$10.00

Property Address: 865 North Ave.

Property Tax No: 2945-141-03-014

Subdivision: \_\_\_\_\_

Property Owner: Mearchams Inc

Owner's Telephone: (970) 243-0634

Owner's Address: 865 North Ave

Contractor's Name: J&S Fence Company Inc

Contractor's Telephone: (970) 243-2723

Contractor's Address: 2886 J-70 Bus loop, Grand Junction, CO 81501

Fence Material & Height: 6' high Chain link

Plot plan must show property lines and property dimensions, all easements, all rights-of-way, all structures, all setbacks from property lines, and fence height(s). NOTE: Property line is likely one foot or more behind the sidewalk.

THIS SECTION TO BE COMPLETED BY COMMUNITY DEVELOPMENT DEPARTMENT STAFF	
ZONE <u>C-1</u>	SETBACKS: Front _____ from property line (PL) or
SPECIAL CONDITIONS _____	_____ from center of ROW, whichever is greater.
_____	Side _____ from PL Rear _____ from PL

Fences exceeding six feet in height require a separate permit from the City/County Building Department. A fence constructed on a corner lot that extends past the rear of the house along the side yard or abuts an alley requires approval from the City Engineer (Section 4.1.J of the Grand Junction Zoning and Development Code).

The owner/applicant must correctly identify all property lines, easements, and rights-of-way and ensure the fence is located within the property's boundaries. Covenants, conditions, restrictions, easements and/or rights-of-way may restrict or prohibit the placement of fence(s). The owner/applicant is responsible for compliance with covenants, conditions, and restrictions which may apply. Fences built in easements may be subject to removal at the property owner's sole and absolute expense. Any modification of design and/or material as approved in this fence permit must be approved, in writing, by the Community Development Department Director.

I hereby acknowledge that I have read this application and the information and plot plan are correct; I agree to comply with any and all codes, ordinances, laws, regulations, or restrictions which apply. I understand that failure to comply shall result in legal action, which may include but not necessarily be limited to removal of the fence(s) at the owner's cost.

Applicant's Signature [Signature]

Date 10-30-07

Community Development's Approval [Signature]

Date 10-30-07

City Engineer's Approval (if required) \_\_\_\_\_

Date \_\_\_\_\_

VALID FOR SIX MONTHS FROM DATE OF ISSUANCE (Section 2.2.E.1.d Grand Junction Zoning & Development Code)

(White: Community Development) (Yellow: Applicant) (Pink: Code Enforcement)

# City of Grand Junction GIS City Map ©

**Parcels**  
□ Address Label

**Air Photos**  
■ 2007 Photos

— Highways

— Street Labels

**City Limits**  
■ Grand Junction  
■ Fruita  
■ Palisade  
□ Mesa County



SCALE 1 : 785

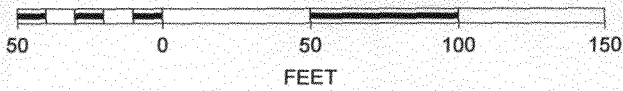



J & S FENCE COMPANY INC.  
2886 I-70 BUSINESS LOOP  
GRAND JUNCTION, COLORADO 81501  
(970) 243-2723 (FAX) 243-2735

JOB SKETCH

BILL TO:

AMERICAN FURNITURE  
KEVEN MEACHAM, MANAGER (970) 243-0634  
865 NORTH AVENUE  
GRAND JUNCTION, COLORADO 81501

SHIP TO:

SAVED: CLSB/AMERICANFURNITURE  
SEE: ED  
FAX: (970) 242-7471, ATTN: KEVIN

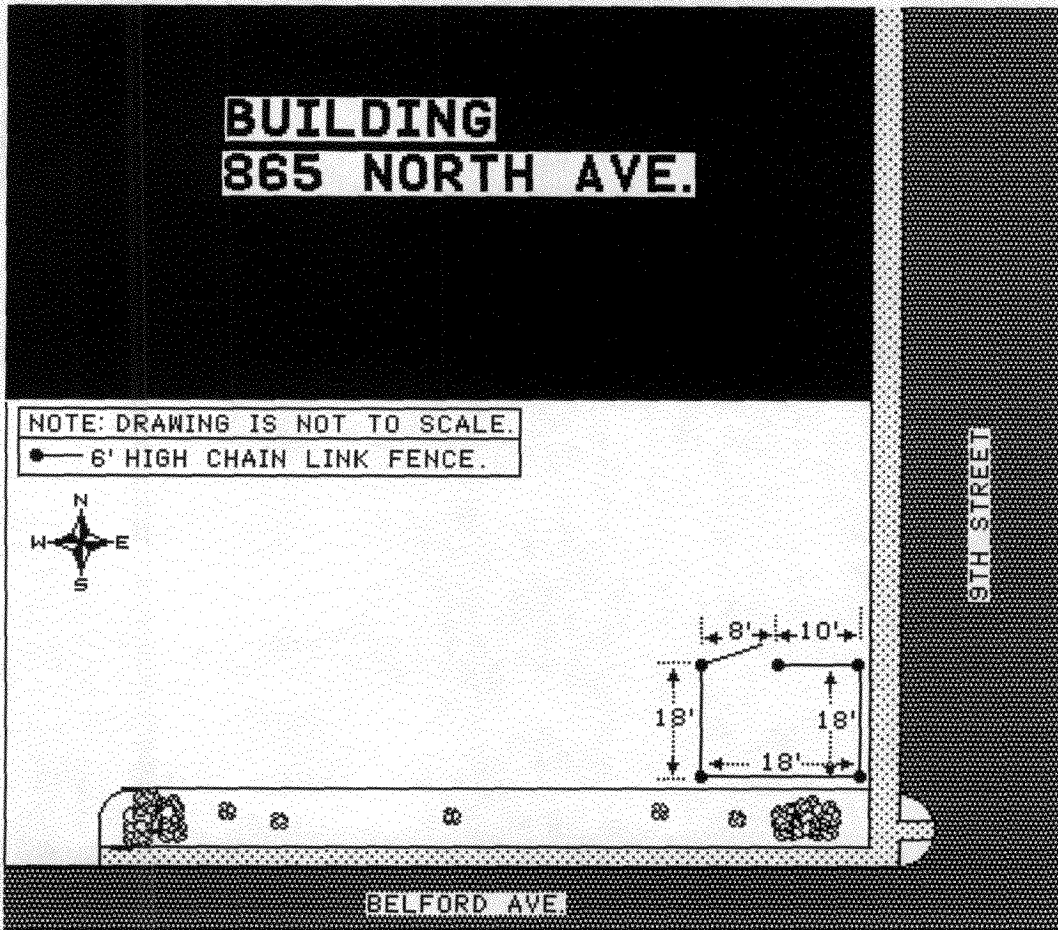

10/4/2007