



# Fence Permit

PERMIT # 15009

Community Development Department  
250 North 5<sup>th</sup> Street  
Grand Junction, CO 81501  
Phone: (970) 244-1430 FAX (970) 236-4031

FEE \$10.00

Property Address: 2854 Chamowitz Dr B.S. 81501  
 Property Tax No: 2943-191-42-004  
 Subdivision: WHITE WILLOW  
 Property Owner: David Bradford  
 Owner's Telephone: dr. 970-0869  
 Owner's Address: 2856 Chamowitz Dr  
 Contractor's Name: Don Boyles  
 Contractor's Telephone: N/A  
 Contractor's Address: N/A  
 Fence Material & Height: Cedar, 6' split rail 48" cedar

Plot plan must show property lines and property dimensions, all easements, all rights-of-way, all structures, all setbacks from property lines, and fence height(s). NOTE: Property line is likely one foot or more behind the sidewalk.

**THIS SECTION TO BE COMPLETED BY COMMUNITY DEVELOPMENT DEPARTMENT STAFF**

ZONE R-4 SETBACKS: Front 20 from property line (PL) or  
 SPECIAL CONDITIONS \_\_\_\_\_ from center of ROW, whichever is greater.  
 Side 0 from PL Rear 0 from PL

Fences exceeding six feet in height require a separate permit from the City/County Building Department. A fence constructed on a corner lot that extends past the rear of the house along the side yard or abuts an alley requires approval from the City Engineer (Section 4.1.J of the Grand Junction Zoning and Development Code).

The owner/applicant must correctly identify all property lines, easements, and rights-of-way and ensure the fence is located within the property's boundaries. Covenants, conditions, restrictions, easements and/or rights-of-way may restrict or prohibit the placement of fence(s). The owner/applicant is responsible for compliance with covenants, conditions, and restrictions which may apply. Fences built in easements may be subject to removal at the property owner's sole and absolute expense. Any modification of design and/or material as approved in this fence permit must be approved, in writing, by the Community Development Department Director.

I hereby acknowledge that I have read this application and the information and plot plan are correct; I agree to comply with any and all codes, ordinances, laws, regulations, or restrictions which apply. I understand that failure to comply shall result in legal action, which may include but not necessarily be limited to removal of the fence(s) at the owner's cost.

Applicant's Signature [Signature] Date 10/23/07  
 Community Development's Approval Judith A. [Signature] Date 10/23/07  
 City Engineer's Approval (if required) \_\_\_\_\_ Date \_\_\_\_\_

**VALID FOR SIX MONTHS FROM DATE OF ISSUANCE (Section 2.2.E.1.d Grand Junction Zoning & Development Code)**

(White: Community Development) (Yellow: Applicant) (Pink: Code Enforcement)

# City of Grand Junction GIS Zoning Map ©

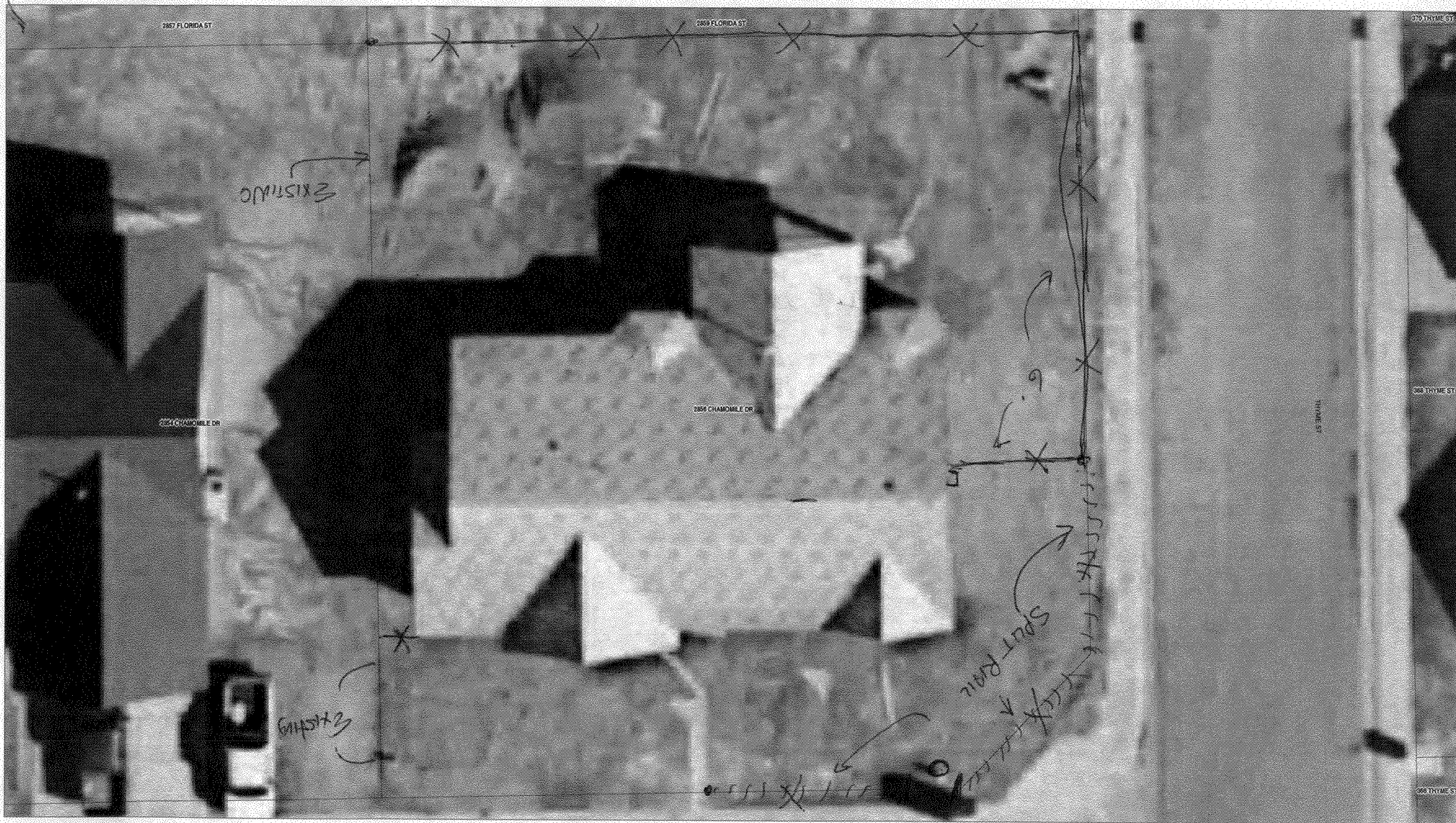

SCALE 1 : 224

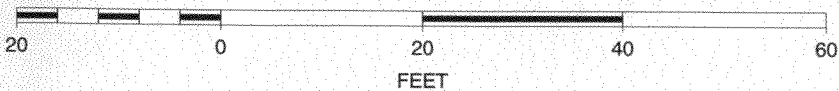

2856 Chamomile Dr.

