



Fence Permit

PERMIT # **Nº** 15464

Public Works & Planning Department
250 North 5th Street
Grand Junction, CO 81501
Phone: (970) 244-1430 FAX: (970) 256-4031

Fee \$10.00

Property Address: 2952 Red Cloud Lane

Property Tax No: 2943-174-43-001

Subdivision: Country Place Estates

Property Owner: Nicole Moreno

Owner's Telephone: 970-778-1999 cell 970-244-2135 wk

Owner's Address: SAA

Contractor's Name: SCIF

Contractor's Telephone: _____

Contractor's Address: _____

Fence Material & Height: 6 Foot Cedar

Plot plan must show property lines and property dimensions, all easements, all rights-of-way, all structures, all setbacks from property lines, and fence height(s). NOTE: Property line is likely one foot or more behind the sidewalk.

THIS SECTION TO BE COMPLETED BY PLANNING STAFF

ZONE <u>R-8</u>	SETBACKS: Front _____ from property line (PL) or
SPECIAL CONDITIONS <u>Site Dist OK</u>	_____ from center of ROW, whichever is greater.
	Side _____ from PL Rear _____ from PL

Fences exceeding six feet in height require a separate permit from the City/County Building Department. A fence constructed on a corner lot that extends past the rear of the house along the side yard or abuts an alley requires approval from the City Engineer (Section 4.1.J of the Grand Junction Zoning and Development Code).

The owner/applicant must correctly identify all property lines, easements, and rights-of-way and ensure the fence is located within the property's boundaries. Covenants, conditions, restrictions, easements and/or rights-of-way may restrict or prohibit the placement of fence(s). The owner/applicant is responsible for compliance with covenants, conditions, and restrictions which may apply. Fences built in easements may be subject to removal at the property owner's sole and absolute expense. Any modification of design and/or material as approved in this fence permit must be approved, in writing, by the Public Works & Planning Department Director.

I hereby acknowledge that I have read this application and the information and plot plan are correct; I agree to comply with any and all codes, ordinances, laws, regulations, or restrictions which apply. I understand that failure to comply shall result in legal action, which may include but not necessarily be limited to removal of the fence(s) at the owner's cost.

Applicant's Signature Nicole Moreno Date 7-7-08

Planning Approval Paul Hornbeck Date 7-7-08

City Engineer's Approval (if required) _____ Date _____

VALID FOR SIX MONTHS FROM DATE OF ISSUANCE (Section 2.2.E.1.d Grand Junction Zoning & Development Code)

(White: Planning)

(Yellow: Applicant)

(Pink: Neighborhood Services)

05/22/2008 THU 8:12 FAX 970 255 1724 St. Marys Phys. Billing

002/002

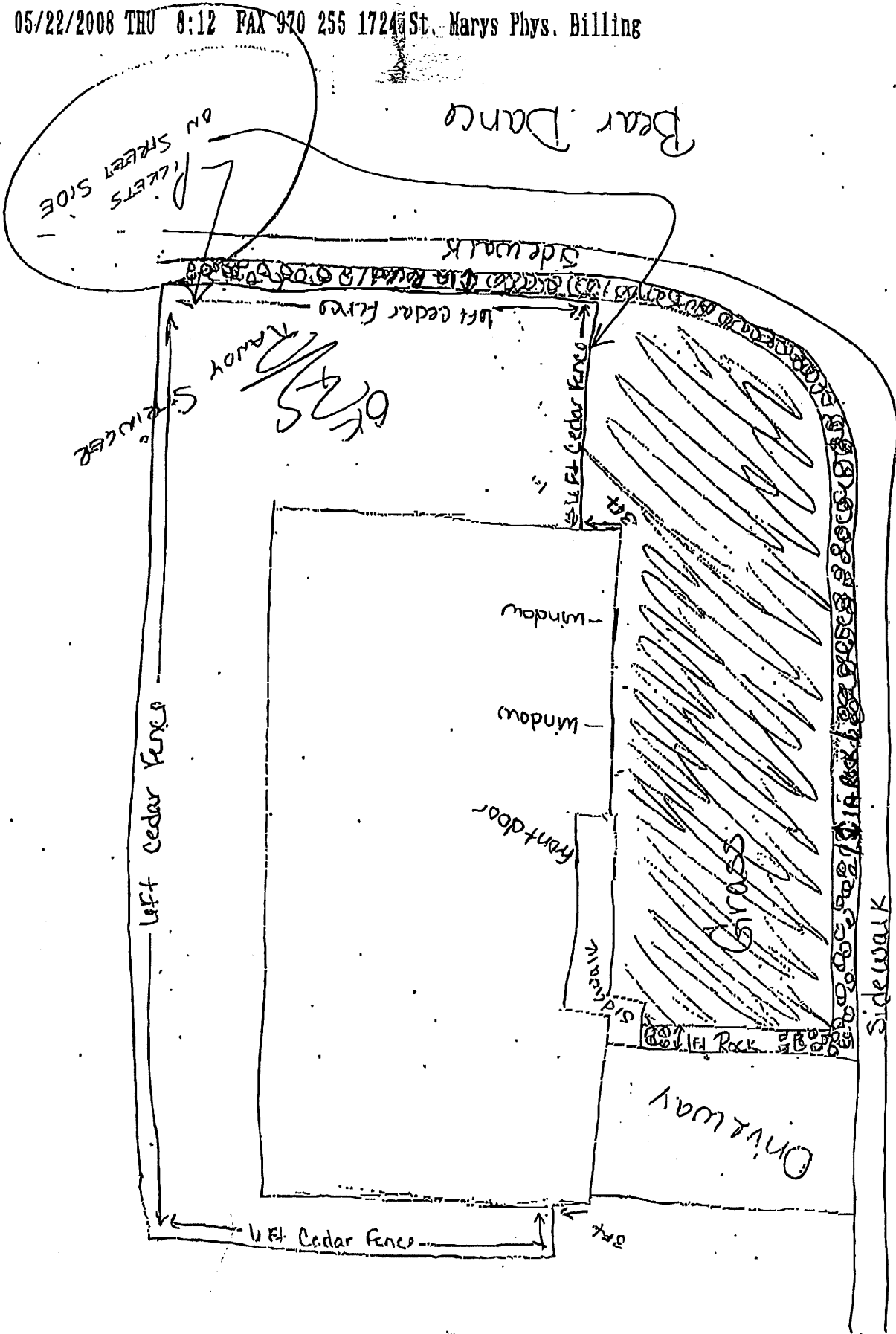

Red Cloud Ln

Bear Dance

ON STREET SIDE
PILLETTS SIDE

left cedar fence

67425
KAWAY

Window

Window

front door

Sidewalk

Grass

Sidewalk

DRIVEWAY

left cedar fence

2752 Red Cloud