

Fence Permit

PERMIT # **Nº** 15342

Public Works & Planning Department
250 North 5th Street
Grand Junction, CO 81501
Phone: (970) 244-1430 FAX: (970) 256-4031

Fee \$10.00

Property Address: 2433 Texas Ave
 Property Tax No: 2945-124-09-009
 Subdivision: Wilcox & Bixby
 Property Owner: Marsha Overdorf
 Owner's Telephone: —
 Owner's Address: Same as above
 Contractor's Name: J&S Fence Company, Inc.
 Contractor's Telephone: (970) 243-2723
 Contractor's Address: 2886 I-70 Bus Loop, Grand Jct., CO 81501
 Fence Material & Height: 4' High Chain Link

Plot plan must show property lines and property dimensions, all easements, all rights-of-way, all structures, all setbacks from property lines, and fence height(s). NOTE: Property line is likely one foot or more behind the sidewalk.

THIS SECTION TO BE COMPLETED BY PLANNING STAFF

ZONE <u>R-8</u>	SETBACKS: Front <u>20</u> from property line (PL) or
SPECIAL CONDITIONS _____	_____ from center of ROW, whichever is greater.
_____	Side <u>0</u> from PL Rear <u>0</u> from PL

Fences exceeding six feet in height require a separate permit from the City/County Building Department. A fence constructed on a corner lot that extends past the rear of the house along the side yard or abuts an alley requires approval from the City Engineer (Section 4.1.J of the Grand Junction Zoning and Development Code).

The owner/applicant must correctly identify all property lines, easements, and rights-of-way and ensure the fence is located within the property's boundaries. Covenants, conditions, restrictions, easements and/or rights-of-way may restrict or prohibit the placement of fence(s). The owner/applicant is responsible for compliance with covenants, conditions, and restrictions which may apply. Fences built in easements may be subject to removal at the property owner's sole and absolute expense. Any modification of design and/or material as approved in this fence permit must be approved, in writing, by the Public Works & Planning Department Director.

I hereby acknowledge that I have read this application and the information and plot plan are correct; I agree to comply with any and all codes, ordinances, laws, regulations, or restrictions which apply. I understand that failure to comply shall result in legal action, which may include but not necessarily be limited to removal of the fence(s) at the owner's cost.

Applicant's Signature Eva Downey Date 3/31/09
 Planning Approval Lynne Reynolds Date 4/2/09
 City Engineer's Approval (if required) _____ Date _____

VALID FOR SIX MONTHS FROM DATE OF ISSUANCE (Section 2.2.E.1.d Grand Junction Zoning & Development Code)

(White: Planning)

(Yellow: Applicant)

(Pink: Neighborhood Services)

TEXAS AVE



NOTE: DRAWING IS NOT TO SCALE
●— 4' HIGH CHAIN LINK FENCE

#15342

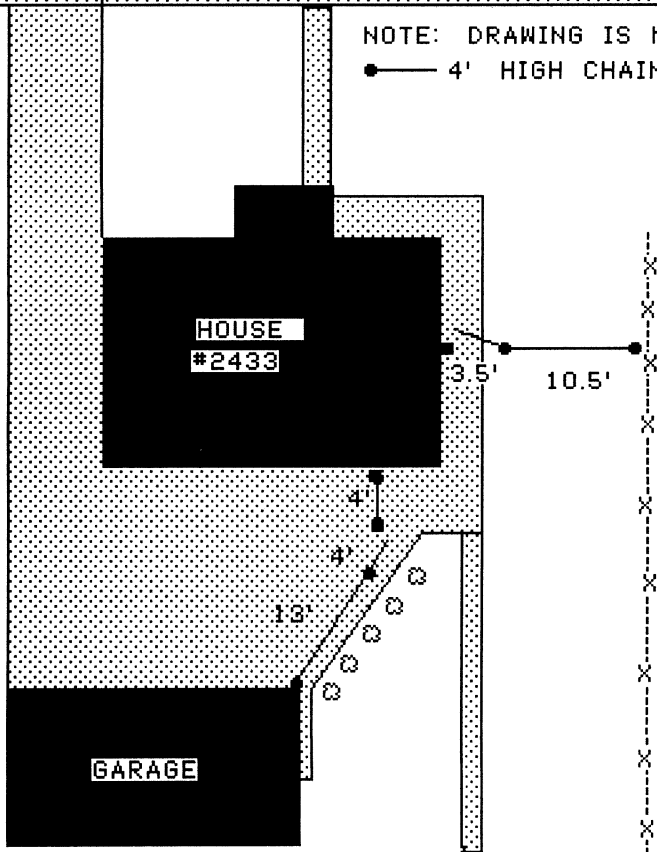

City of Grand Junction GIS City Map ©

#15342

Parcels

 Address Label

Air Photos

 2008 Photos

 Highways

 Street Labels

City Limits

 Grand Junction

 Fruita

 Palisade

 Mesa County

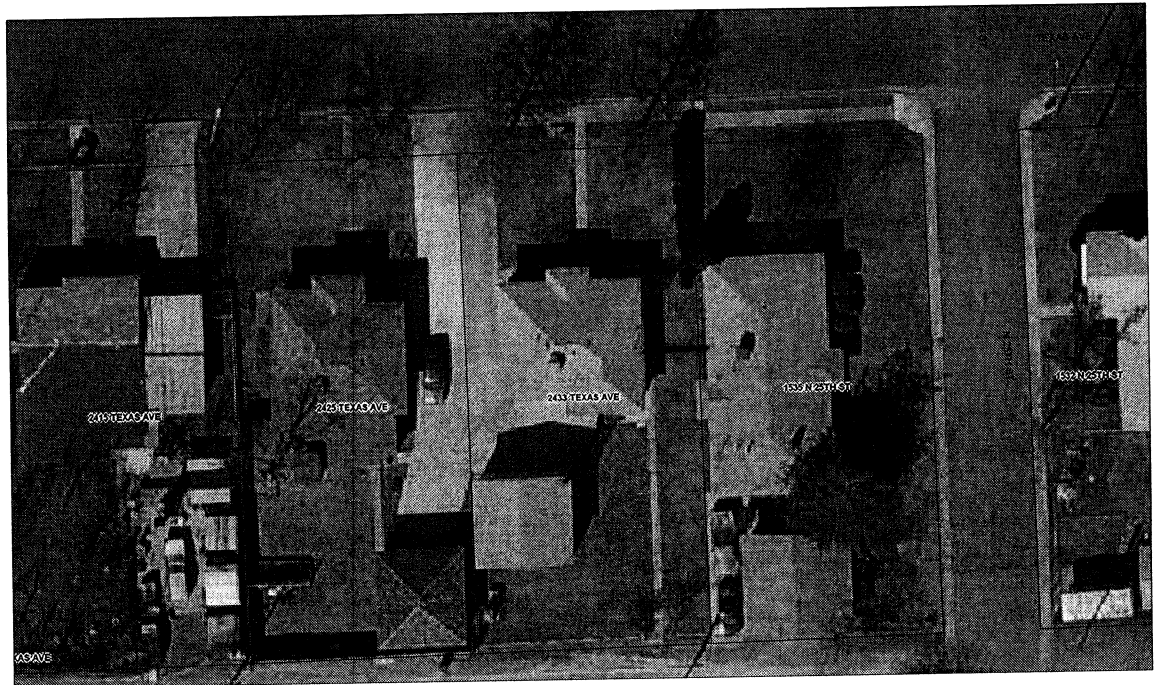

SCALE 1 : 590

