

Fence Permit

PERMIT # N^o 16142

Public Works & Planning Department
250 North 5th Street
Grand Junction, CO 81501
Phone: (970) 244-1430 FAX: (970) 256-4031

Fee \$10.00

Property Address: 171 Sun Hawk DR
 Property Tax No: 2943-321-27-005
 Subdivision: Hawks Nest
 Property Owner: 30 Rd, LLC
 Owner's Telephone: 242-8134
 Owner's Address: 710 S 15th St.
 Contractor's Name: Steady Const
 Contractor's Telephone: 250-7244
 Contractor's Address: 761 25 Rd
 Fence Material & Height: 6' Vinyl

Plot plan must show property lines and property dimensions, all easements, all rights-of-way, all structures, all setbacks from property lines, and fence height(s). NOTE: Property line is likely one foot or more behind the sidewalk.

THIS SECTION TO BE COMPLETED BY PLANNING STAFF

ZONE R-4 SETBACKS: Front _____ from property line (PL) or
 SPECIAL CONDITIONS _____ from center of ROW, whichever is greater.
 Side _____ from PL Rear _____ from PL

Fences exceeding six feet in height require a separate permit from the City/County Building Department. A fence constructed on a corner lot that extends past the rear of the house along the side yard or abuts an alley requires approval from the City Engineer (Section 4.1.J of the Grand Junction Zoning and Development Code).

The owner/applicant must correctly identify all property lines, easements, and rights-of-way and ensure the fence is located within the property's boundaries. Covenants, conditions, restrictions, easements and/or rights-of-way may restrict or prohibit the placement of fence(s). The owner/applicant is responsible for compliance with covenants, conditions, and restrictions which may apply. Fences built in easements may be subject to removal at the property owner's sole and absolute expense. Any modification of design and/or material as approved in this fence permit must be approved, in writing, by the Public Works & Planning Department Director.

I hereby acknowledge that I have read this application and the information and plot plan are correct; I agree to comply with any and all codes, ordinances, laws, regulations, or restrictions which apply. I understand that failure to comply shall result in legal action, which may include but not necessarily be limited to removal of the fence(s) at the owner's cost.

Applicant's Signature [Signature] Date 8-17-10
 Planning Approval Gayleen Henderson Date 8-17-10
 City Engineer's Approval (if required) _____ Date _____

VALID FOR SIX MONTHS FROM DATE OF ISSUANCE (Section 2.2.E.1.d Grand Junction Zoning & Development Code)

(White: Planning)

(Yellow: Applicant)

(Pink: Neighborhood Services)

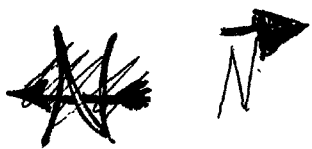

Sun Hawk Dr

87.80'

10' IRRIGATION

7-29-10

Boyle
PD
Hester

46'

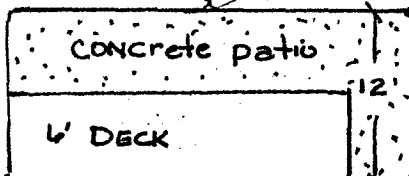

104.00'

12.8'

68'

Elect Meter

36' 30"

3 CAR GARAGE

GATE

Covered Porch

CONCRETE DRIVEWAY

22'

14' MULTI PURPOSE EASEMENT

WATER TAP

33'

Driveway OK
Ret 7/28/10

171 Sun Hawk Dr
LOT 5 BIK & Hawks Nest
9132 #
Fil One