

DATE SUBMITTED: 12-10-93

PERMIT # _____

FEE 5.00

FENCE PERMIT

GRAND JUNCTION PLANNING DEPARTMENT

BLDG ADDRESS: 585 25 1/2 rd

TAX SCHEDULE #: 2945-102-00-100

PROPERTY OWNER: Paradise Valley Mobile Home Park

PHONE: 242-0049

CONTRACTOR: Fireside Construction

PHONE: 404-0823

MATERIAL: cedar

HEIGHT: 6'

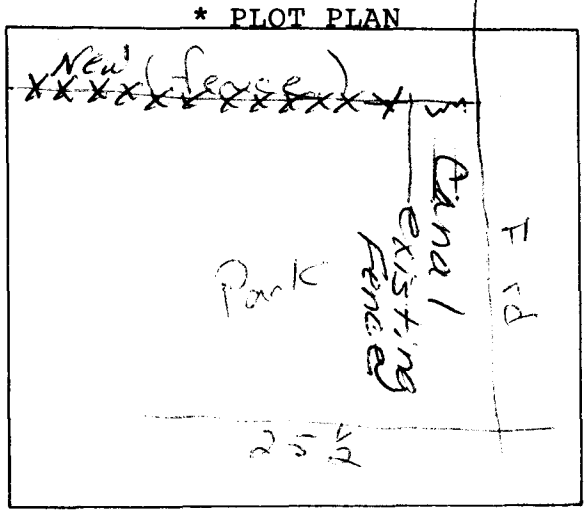

*Showing Property Line Dimensions, Easements, Streets, all Structures, and Setbacks from Property Lines.

FOR OFFICE USE ONLY

ZONE: PmH

SETBACKS: F _____ S _____ R _____

SPECIAL CONDITIONS: _____

FINAL PERMIT

WILL REQUIRE SEPARATE PERMIT FROM THE CITY/COUNTY BUILDING DEPARTMENT.

ANY MODIFICATION TO THIS APPROVED FENCE PERMIT MUST BE APPROVED, IN WRITING, BY THIS DEPARTMENT.

I HEREBY ACKNOWLEDGE THAT I HAVE READ THIS APPLICATION AND THE ABOVE IS CORRECT, AND I AGREE TO COMPLY WITH THE REQUIREMENTS ABOVE. FAILURE TO COMPLY SHALL RESULT IN LEGAL ACTION.

Chris J. Slaves
SIGNATURE

APPROVED BY: Marcia Peltz
DATE APPROVED: 12-10-93