

SIGN PERMIT APPLICATION

ELEC MESA 1373

Permit No. 00015
 Value 9.50⁰⁰
 Fee 5.00

Date 12/20/84

Business Name Columbus Evangelical Free Church
 Business Address 2711 Unaweep

Street Frontage - Front 340' Side 155'
 Building Frontage - Front 120' Side 96'
 Traffic Lane - Front Side
 Height of Sign - 7' Clearance to Grade 3'

Area of Sign 22 S.F. Area of Existing Signs NONE S.F.
 TOTAL ALLOWED AREA - Front S.F. Side S.F.

		TYPE OF SIGN	
On Premise	<input checked="" type="checkbox"/>	Off Premise	<input type="checkbox"/>
Business	<input type="checkbox"/>	Residential	<input type="checkbox"/>
Free Standing	<input type="checkbox"/>	Ground	<input checked="" type="checkbox"/>
Projecting	<input type="checkbox"/>	Roof	<input type="checkbox"/>
Bulletin	<input type="checkbox"/>	Identification	<input type="checkbox"/>
Other	<input type="checkbox"/>	Flush Wall	<input type="checkbox"/>
		Illuminated	<input checked="" type="checkbox"/>

Description Sign on 2 Steel poles

Owner Columbus Church
 Address 2711 Unaweep
 Contractor W. L. Brown New
 Address 456 N.E. Ave

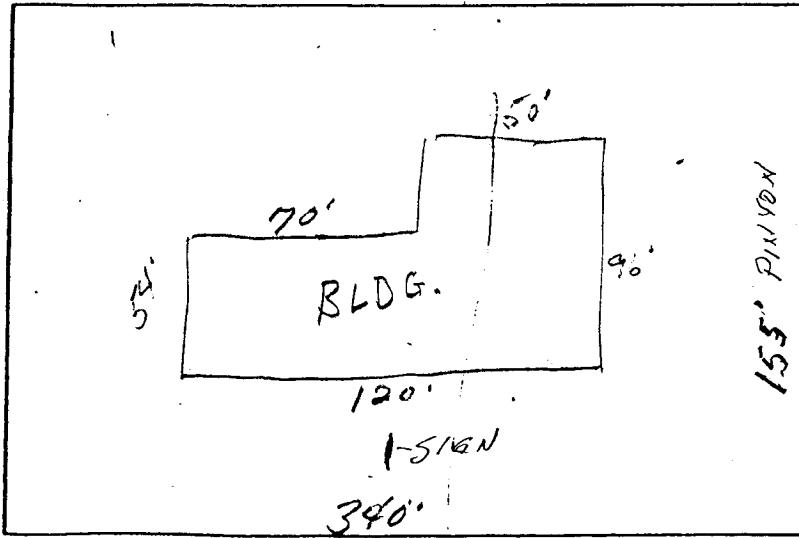

Sketch:
 Streets, property lines, proposed sign location.

Permit

[Signature]
 Planning Department 1/7/85

[Signature]
 Applicant
 Building Department