

SIGN PERMIT APPLICATION

Permit No. 00045

Date 1/7/85

Value 1200⁰⁰

Fee 10⁰⁰

Business Name Don Huskin Motors

Business Address 310 So 12th

Street Frontage - Front _____ Side _____

Building Frontage - Front _____ Side _____

Traffic Lane - Front _____ Side _____

Height of Sign - _____ Clearance to Grade _____

Area of Sign 66 S.F.

Area of Existing Signs _____ S.F.

TOTAL ALLOWED AREA - Front _____ S.F.

Side _____ S.F.

TYPE OF SIGN

On Premise

Off Premise _____

Business

Residential _____

Free Standing

Ground _____

Projecting _____

Roof _____

Flush Wall _____

Bulletin _____

Identification _____

Illuminated

Other _____

Description Change sign to read Don Huskin

Owner Don Huskin
Address 310 So 12th
Contractor Western Neon
Address 456 N.E. Ave

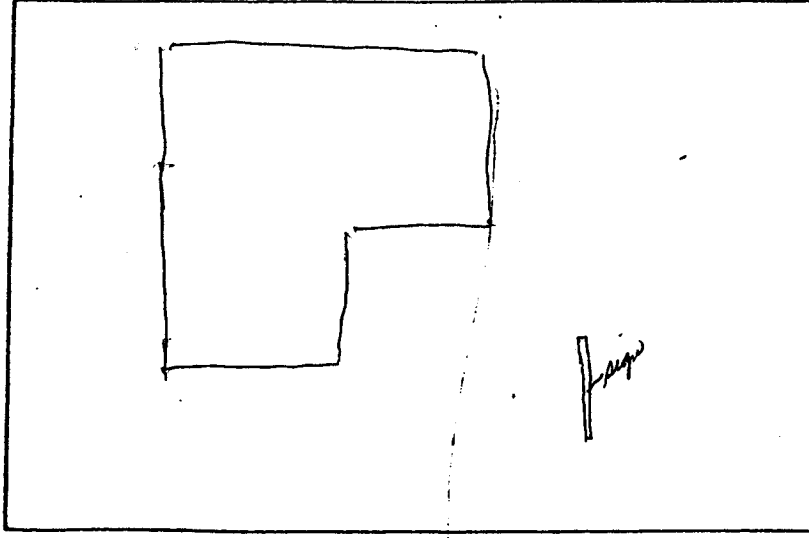

Sketch:
Streets, property lines, proposed sign location.

Permit

Front post to be moved in 6 mos.

Don

Planning Department 1/7/85

[Signature]
Applicant

Building Department



JESSE BOYCE MOTORS, INC.
310 SOUTH 12th ST.



JANUARY 4, 1985

Don Warner
Grand Junction Planning Dept.

Per our conversation of today I am putting into writing my assurance that our free standing sign located on 12 th street will meet all all city sign regulations on or before July 1, 1985. I understand this will require the removal of the post closest to 12th Street. I appreciate your help and understanding in this matter.



Sincerely,

Don Gaskin
President, Jesse Boyce Motors