

DATE SUBMITTED: 6/27/85

PERMIT # _____

FEE 10.00

~~MESA Co.~~ GRAND JCT. **SIGN PERMIT**
~~CORNER~~ PLANNING DEPARTMENT

BUSINESS NAME: Capital Business Systems

BUSINESS ADDRESS: 637 NO. AVE

STREET FRONTAGE: FRONT 55' FT. SIDE 150' FT.

BUILDING FRONTAGE: FRONT 35' FT. SIDE _____ FT.

TRAFFIC LANE: FRONT 4 SIDE _____

HEIGHT OF SIGN: 12' FT. CLEARANCE TO GRADE: 10' FT.

AREA OF SIGN: 64 SQ. FT. AREA OF EXISTING SIGNS: NONE SQ. FT.

TOTAL ALLOWED AREA: FRONT 70 SQ. FT. SIDE _____ SQ. FT.

TYPE OF SIGN

- ON PREMISE
- OFF PREMISE
- FREE STANDING
- PROJECTING
- ROOF
- FLUSH WALL
- ILLUMINATED
- OTHER

COMMENTS 3 signs on bldg.

*SKETCH

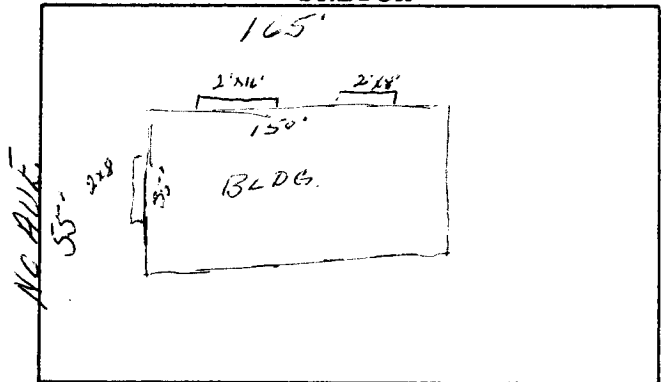

*Include: Streets, Property Lines, Proposed Sign Location.

PROPERTY OWNER: Capital Business Systems

ADDRESS: 637 No. Ave

CONTRACTOR: Western Neon

ADDRESS: 456 No. Ave

PHONE: _____

[Signature]
Signature

APPROVED BY: [Signature]

DATE APPROVED: 6/27/85

- FINAL PERMIT
- WILL REQUIRE SEPARATE PERMIT