

DATE SUBMITTED: 5/23/86

PERMIT # _____

FEE 10⁰⁰

SIGN PERMIT

GRAND JUNCTION PLANNING DEPARTMENT

BUSINESS NAME: Travelers Inn

BUSINESS ADDRESS: 704 Horizon Drive

STREET FRONTAGE: FRONT 204' FT. SIDE 462' FT.

BUILDING FRONTAGE: FRONT 175' FT. SIDE 325' FT.

TRAFFIC LANE: FRONT 4 SIDE 2

HEIGHT OF SIGN: 40' FT. CLEARANCE TO GRADE: 14' FT.

AREA OF SIGN: 240⁰ SQ. FT. AREA OF EXISTING SIGNS: NONE SQ. FT.

TOTAL ALLOWED AREA: FRONT 300 SQ. FT. SIDE _____ SQ. FT.

TYPE OF SIGN

- ON PREMISE
- OFF PREMISE
- FREE STANDING
- PROJECTING
- ROOF
- FLUSH WALL
- ILLUMINATED
- OTHER

COMMENTS Replace present sign
With new sign

*SKETCH

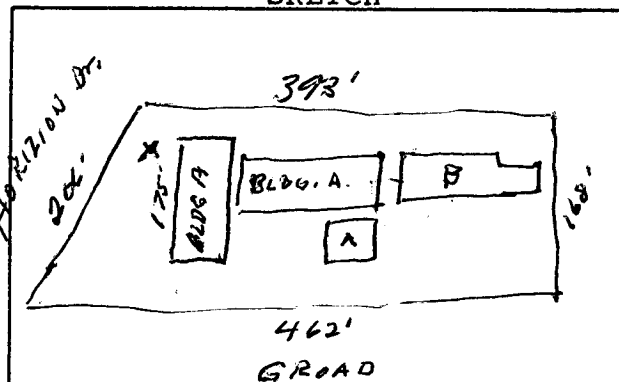

*Include: Streets, Property Lines, Proposed Sign Location.

PROPERTY OWNER: Travelers Inn

ADDRESS: 704 Horizon Dr.

CONTRACTOR: Western Mass

ADDRESS: 456 No. Ave.

PHONE: _____

[Signature]
Signature

APPROVED BY: [Signature]

DATE APPROVED: _____

- FINAL PERMIT
- WILL REQUIRE SEPARATE PERMIT