

DATE SUBMITTED: 8/19/85

Waves & Co. # 379

PERMIT # \_\_\_\_\_

FEE 10.00  
2 signs

# SIGN PERMIT

GRAND JUNCTION PLANNING DEPARTMENT

BUSINESS NAME: Motorcycle Accessories

BUSINESS ADDRESS: 2060 main

STREET FRONTAGE: FRONT 100' FT. SIDE 150' FT.

BUILDING FRONTAGE: FRONT 65' FT. SIDE 100' FT.

TRAFFIC LANE: FRONT 4' FT. SIDE \_\_\_\_\_ FT.

HEIGHT OF SIGN: 15' FT. CLEARANCE TO GRADE: 12' FT.

AREA OF SIGN: 30" x 36" SQ. FT. AREA OF EXISTING SIGNS: \_\_\_\_\_ SQ. FT.

TOTAL ALLOWED AREA: FRONT 160' SQ. FT. SIDE \_\_\_\_\_ SQ. FT.

### TYPE OF SIGN

- ON PREMISE
- OFF PREMISE
- FREE STANDING
- PROJECTING
- ROOF
- FLUSH WALL
- ILLUMINATED
- OTHER

COMMENTS Signs on bldg  
3'x10 + 3'x12'

### \*SKETCH

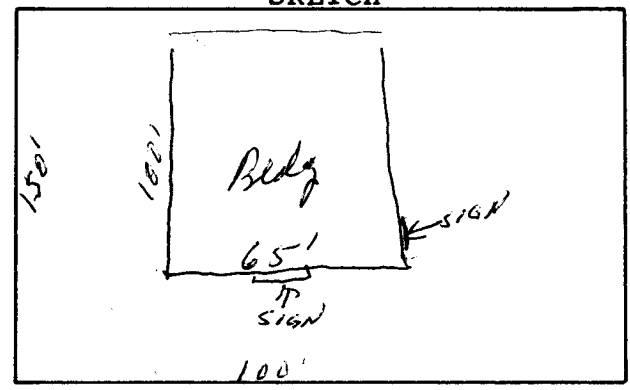

\*Include: Streets, Property Lines, Proposed Sign Location.

PROPERTY OWNER: Motorcycle Accessories  
ADDRESS: 2060 main

[Signature]  
Signature

CONTRACTOR: Western Beams  
ADDRESS: 456 No. Ave

APPROVED BY: [Signature]

PHONE: 242-7843

DATE APPROVED: 8/19/85

- FINAL PERMIT
- WILL REQUIRE SEPARATE PERMIT