

B+R #350

DATE SUBMITTED: 7-8-86

PERMIT # _____

FEE \$75⁰⁰

SIGN PERMIT

GRAND JUNCTION PLANNING DEPARTMENT

BUSINESS NAME: A-1 Muffler

BUSINESS ADDRESS: 340 So 13th

STREET FRONTAGE: FRONT 105 FT. SIDE 126' FT.

BUILDING FRONTAGE: FRONT 35 FT. SIDE 90' FT.

TRAFFIC LANE: FRONT 2 FT. SIDE 4 FT.

HEIGHT OF SIGN: 16' FT. CLEARANCE TO GRADE: 12' FT.

AREA OF SIGN: PAINTED - on BLDG, PITKIN - 1420'
PAINTED ON 13th 50⁰⁰ SQ. FT.
pole sign 32.0' AREA OF EXISTING SIGNS: NONE SQ. FT.

TOTAL ALLOWED AREA: FRONT 78 SQ. FT. SIDE 180 SQ. FT.

TYPE OF SIGN

- ON PREMISE
- OFF PREMISE
- FREE STANDING
- PROJECTING
- ROOF
- FLUSH WALL
- ILLUMINATED
- OTHER

COMMENTS PITKIN - BLDG Painted signs
13th St. pole sign + painted sign

*Electrical connection
to be put underground.*

PROPERTY OWNER: A-1 Muffler

ADDRESS: 340 So 13th

CONTRACTOR: Western New

ADDRESS: 456 NO ave

PHONE: 242-7843

*SKETCH

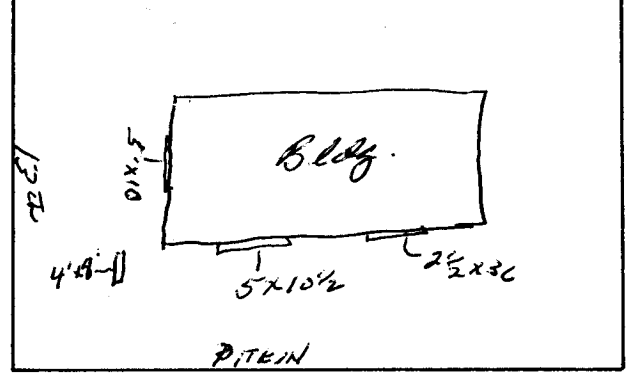

*Include: Streets, Property Lines, Proposed Sign Location.

[Signature]
Signature

APPROVED BY: Linda

DATE APPROVED: 7-8-86

*Total West side
to be reduced
to 78*

- FINAL PERMIT
- WILL REQUIRE SEPARATE PERMIT