

DATE SUBMITTED: 8-12-86

PERMIT # _____

FEE \$10.00

SIGN PERMIT

GRAND JUNCTION PLANNING DEPARTMENT

BUSINESS NAME: SCOTTY MUFFLER

BUSINESS ADDRESS: 405 PITKIN AVE.

STREET FRONTAGE: FRONT 125 FT. SIDE 75 FT.

BUILDING FRONTAGE: FRONT 80 FT. SIDE 40 FT.

TRAFFIC LANE: FRONT 2 SIDE 4

HEIGHT OF SIGN: 22 FT. CLEARANCE TO GRADE: 10 FT.

AREA OF SIGN: 72 SQ. FT. AREA OF EXISTING SIGNS: _____ SQ. FT.

TOTAL ALLOWED AREA: FRONT 187.50 SQ. FT. SIDE _____ SQ. FT.

TYPE OF SIGN

- | | |
|---|---|
| <input type="checkbox"/> ON PREMISE | <input type="checkbox"/> ROOF |
| <input type="checkbox"/> OFF PREMISE | <input type="checkbox"/> FLUSH WALL |
| <input checked="" type="checkbox"/> FREE STANDING | <input checked="" type="checkbox"/> ILLUMINATED |
| <input type="checkbox"/> PROJECTING | <input type="checkbox"/> OTHER |

COMMENTS _____

*SKETCH

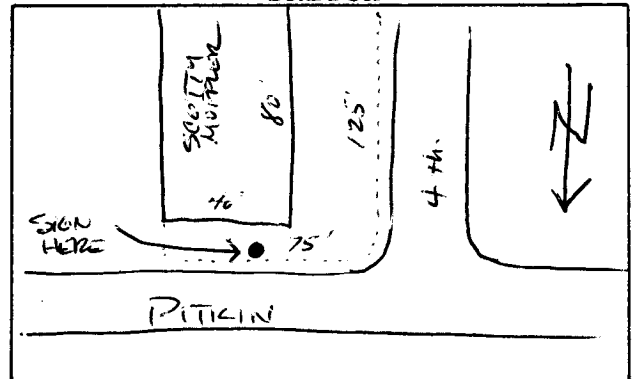

*Include: Streets, Property Lines, Proposed Sign Location.

PROPERTY OWNER: SCOTTY MUFFLER

ADDRESS: 405 PITKIN

CONTRACTOR: SIGNS BY BUD

ADDRESS: 111 N. 22 RD CT.

PHONE: 245-7700

[Signature]
Signature

APPROVED BY: [Signature]

DATE APPROVED: 8/12/86

- FINAL PERMIT
- WILL REQUIRE SEPARATE PERMIT