

DATE SUBMITTED: 3-14-86.

PERMIT # _____

FEE _____

SIGN PERMIT

GRAND JUNCTION PLANNING DEPARTMENT

BUSINESS NAME: MOM'S. BBQ.

BUSINESS ADDRESS: 610. Hwy. 50.

STREET FRONTAGE: FRONT 25' FT. SIDE 30' FT.

BUILDING FRONTAGE: FRONT _____ FT. SIDE _____ FT.

TRAFFIC LANE: FRONT _____ FT. SIDE _____ FT.

HEIGHT OF SIGN: _____ FT. CLEARANCE TO GRADE: _____ FT.

AREA OF SIGN: _____ SQ. FT. AREA OF EXISTING SIGNS: _____ SQ. FT.

TOTAL ALLOWED AREA: FRONT _____ SQ. FT. SIDE _____ SQ. FT.

TYPE OF SIGN

- ON PREMISE
- OFF PREMISE
- FREE STANDING
- PROJECTING
- ROOF
- FLUSH WALL
- ILLUMINATED
- OTHER

COMMENTS _____

*SKETCH

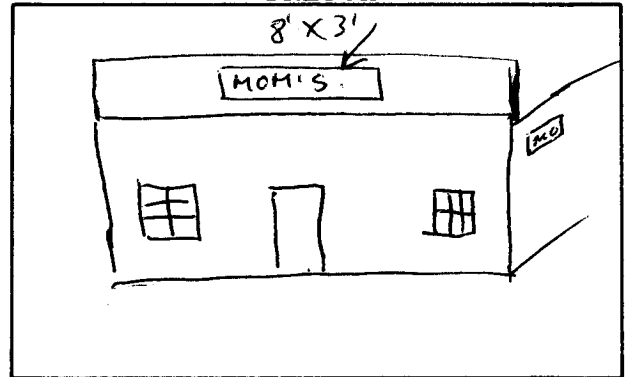

*Include: Streets, Property Lines, Proposed Sign Location.

PROPERTY OWNER: MATTHIAS GRAZES.

ADDRESS: 610. Hwy 50.

CONTRACTOR: Rudy's Painters Conl.

ADDRESS: 197 1/2 Gony View Dr.

PHONE: 243-1409.

Rudy Saint
Signature

APPROVED BY: Linda Wutzel

DATE APPROVED: 3/14/86

- FINAL PERMIT
- WILL REQUIRE SEPARATE PERMIT