

DATE SUBMITTED: 10/1/86

PERMIT # \_\_\_\_\_

FEE 10<sup>00</sup>

# SIGN PERMIT

GRAND JUNCTION PLANNING DEPARTMENT

BUSINESS NAME: MONUMENT POWER WASH 245-3530 Home

BUSINESS ADDRESS: 1010 PITKIN, G.J. 245-2087

STREET FRONTAGE: FRONT 120 FT. SIDE NA FT.

BUILDING FRONTAGE: FRONT 45 FT. SIDE 180 FT.

TRAFFIC LANE: FRONT 1 Way FT. SIDE \_\_\_\_\_ FT.

HEIGHT OF SIGN: 3 FT. CLEARANCE TO GRADE: 3 FT.

AREA OF SIGN: free standing flush wall 6 x 20 SQ. FT. AREA OF EXISTING SIGNS: N/A SQ. FT.

TOTAL ALLOWED AREA: FRONT \_\_\_\_\_ SQ. FT. SIDE \_\_\_\_\_ SQ. FT.

### TYPE OF SIGN

- ON PREMISE
- OFF PREMISE
- FREE STANDING
- PROJECTING
- ROOF
- FLUSH WALL
- ILLUMINATED
- OTHER

COMMENTS free standing sign +  
flush to all signs

### \*SKETCH

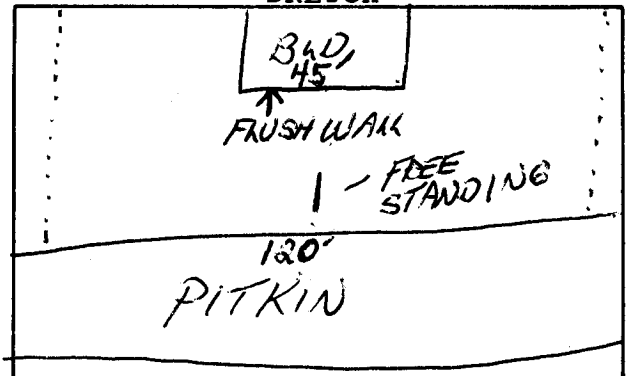

\*Include: Streets, Property Lines, Proposed Sign Location.

Western Now  
James Dickey  
Daniel [redacted] [redacted]

PROPERTY OWNER: CHARLES BAONE

ADDRESS: 1049 ORNOCK, G.J.

CONTRACTOR: Western Now

ADDRESS: 456 No ave

PHONE: 242-7843

APPROVED BY: [Signature]

DATE APPROVED: 10/31/86

- FINAL PERMIT
- WILL REQUIRE SEPARATE PERMIT