

DATE SUBMITTED: 11/12/86

PERMIT # \_\_\_\_\_

FEE \$10<sup>00</sup>

(2 Signs)

# SIGN PERMIT

GRAND JUNCTION PLANNING DEPARTMENT

BUSINESS NAME: THE HAIR COMPANY.

BUSINESS ADDRESS: 1121 N<sup>TH</sup> AVE

STREET FRONTAGE: FRONT 85' 50' FT. SIDE \_\_\_\_\_ FT.

BUILDING FRONTAGE: FRONT 70' 50' FT. SIDE \_\_\_\_\_ FT.

TRAFFIC LANE: FRONT \_\_\_\_\_ FT. SIDE \_\_\_\_\_ FT.

HEIGHT OF SIGN: 17' FT. CLEARANCE TO GRADE: 14' FT.

AREA OF SIGN: 28 (4x4) (3x4) 2 signs SQ. FT. AREA OF EXISTING SIGNS: 50 35 SQ. FT.

TOTAL ALLOWED AREA: FRONT 170 75 SQ. FT. SIDE \_\_\_\_\_ SQ. FT.

### TYPE OF SIGN

- ON PREMISE
- OFF PREMISE
- FREE STANDING
- PROJECTING
- ROOF
- FLUSH WALL
- ILLUMINATED
- OTHER

COMMENTS MOUNTED ON Existing Pole

BRINKLEY

PROPERTY OWNER: JOH BELLIO

ADDRESS: \_\_\_\_\_

CONTRACTOR: GRAND Jct. SIGNS

ADDRESS: 2915 HILL

PHONE: 245-2950

### \*SKETCH

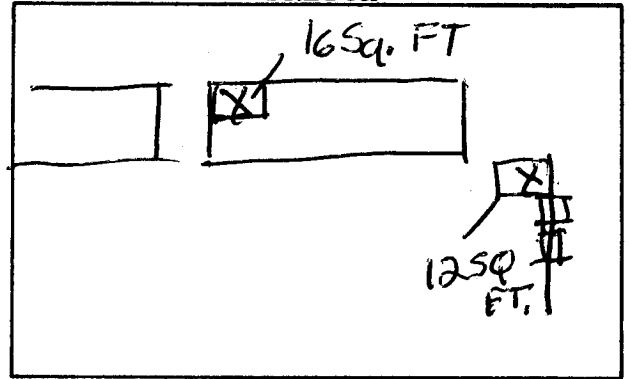

\*Include: Streets, Property Lines, Proposed Sign Location.

Mark Smith  
Signature

APPROVED BY: David

DATE APPROVED: 11/13/86

- FINAL PERMIT
- WILL REQUIRE SEPARATE PERMIT