

DATE SUBMITTED: 9/10/86

PERMIT # \_\_\_\_\_

FEE 5.00

# SIGN PERMIT

GRAND JUNCTION PLANNING DEPARTMENT

BUSINESS NAME: CROSS Electric

BUSINESS ADDRESS: 175.5 B MAIN ST Grand Junction

STREET FRONTAGE: FRONT \_\_\_\_\_ FT. SIDE \_\_\_\_\_ FT.

BUILDING FRONTAGE: FRONT 50' FT. SIDE 80' FT.

TRAFFIC LANE: FRONT \_\_\_\_\_ FT. SIDE \_\_\_\_\_ FT.

HEIGHT OF SIGN: 12 FT. CLEARANCE TO GRADE: 8 FT.

AREA OF SIGN: 24 SQ. FT. AREA OF EXISTING SIGNS: \_\_\_\_\_ SQ. FT.

TOTAL ALLOWED AREA: FRONT 100 SQ. FT. SIDE 100 SQ. FT.

### TYPE OF SIGN

- ON PREMISE
- OFF PREMISE
- FREE STANDING
- PROJECTING
- ROOF
- FLUSH WALL
- ILLUMINATED
- OTHER

COMMENTS 4'x6' Single Face

### \*SKETCH

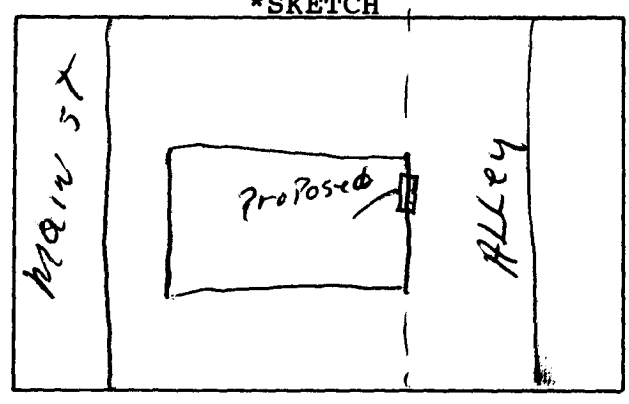

\*Include: Streets, Property Lines, Proposed Sign Location.

PROPERTY OWNER: PAUL Dowdell

Anthony P. Casar  
Signature

ADDRESS: 1755 main St

CONTRACTOR: ECONO SIGNS

ADDRESS: 2330 N. 22nd St

APPROVED BY: [Signature]

PHONE: 243 7446

DATE APPROVED: 9/10/86

- FINAL PERMIT
- WILL REQUIRE SEPARATE PERMIT