

DATE SUBMITTED: 1/29/86

2 signs
PERMIT # _____

FEE 10⁰⁰

SIGN PERMIT

GRAND JUNCTION PLANNING DEPARTMENT

BUSINESS NAME: Chiropractic Center

BUSINESS ADDRESS: 609 No. Ave

STREET FRONTAGE: FRONT 60' FT. SIDE 36' FT.

BUILDING FRONTAGE: FRONT 60' FT. SIDE 36' FT.

TRAFFIC LANE: FRONT 4 FT. SIDE 2 FT.

HEIGHT OF SIGN: ^{2 signs} 11' FT. CLEARANCE TO GRADE: 8' FT.

AREA OF SIGN: ^{2 signs} 2'x11' 4'x12' 56 SQ. FT. AREA OF EXISTING SIGNS: _____ SQ. FT.

TOTAL ALLOWED AREA: FRONT 120 SQ. FT. SIDE 72 SQ. FT.

TYPE OF SIGN

- ON PREMISE
- OFF PREMISE
- FREE STANDING
- PROJECTING
- ROOF
- FLUSH WALL
- ILLUMINATED
- OTHER

COMMENTS Repaint present sign faces

*SKETCH

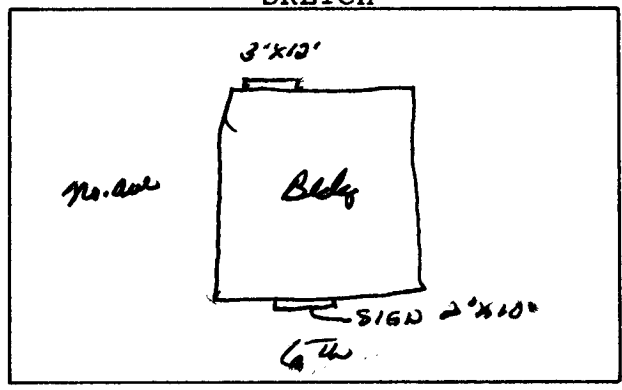

*Include: Streets, Property Lines, Proposed Sign Location.

PROPERTY OWNER: Chiropractic Center

ADDRESS: 609 No. Ave

CONTRACTOR: Western Neon

ADDRESS: 456 No. Ave

PHONE: 242-7843

[Signature]
Signature

APPROVED BY: [Signature]

DATE APPROVED: 1/29/86

No electrical change.

- FINAL PERMIT
- WILL REQUIRE SEPARATE PERMIT