

DATE SUBMITTED: 3/14/86

PERMIT # \_\_\_\_\_

FEE 5.00

# SIGN PERMIT

GRAND JUNCTION PLANNING DEPARTMENT

BUSINESS NAME: Coakley's Laundromat

BUSINESS ADDRESS: 666 Patterson Road Grand Junction

STREET FRONTAGE: FRONT \_\_\_\_\_ FT. SIDE \_\_\_\_\_ FT.

BUILDING FRONTAGE: FRONT 45 FT. SIDE 41 FT.

TRAFFIC LANE: FRONT 3 FT. SIDE Parking Lot FT.

HEIGHT OF SIGN: 12.5 FT. CLEARANCE TO GRADE: 10 FT.

AREA OF SIGN: 37.5 SQ. FT. AREA OF EXISTING SIGNS: 18 SQ. FT.

TOTAL ALLOWED AREA: FRONT 90 SQ. FT. SIDE 82 SQ. FT.

### TYPE OF SIGN

- ON PREMISE
- OFF PREMISE
- FREE STANDING
- PROJECTING
- ROOF
- FLUSH WALL
- ILLUMINATED
- OTHER

COMMENTS 30" x 15' Single Face Sign

\*SKETCH

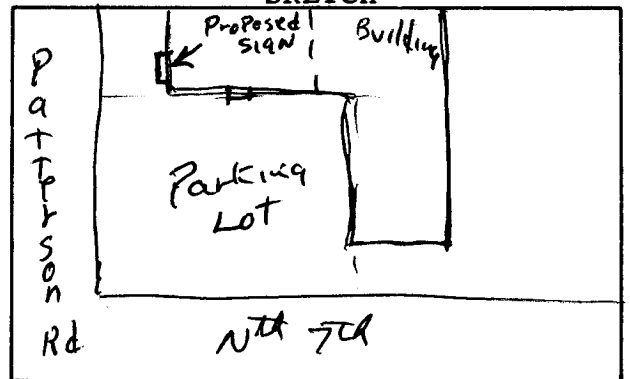

\*Include: Streets, Property Lines, Proposed Sign Location.

PROPERTY OWNER: Dick Coakley

ADDRESS: 666 Patterson

CONTRACTOR: ECONO SIGNS

ADDRESS: 2330 N. 22nd St

PHONE: 243 7446

Signature

APPROVED BY: [Signature]

DATE APPROVED: 3/14/86

- FINAL PERMIT
- WILL REQUIRE SEPARATE PERMIT