

DATE SUBMITTED: FEB. 5, 1987

PERMIT # \_\_\_\_\_

FEE \$10.00

# SIGN PERMIT

GRAND JUNCTION PLANNING DEPARTMENT

BUSINESS NAME: Castle Creek

BUSINESS ADDRESS: 105 W. MAIN ~~1st & Main~~

STREET FRONTAGE: FRONT 225 FT. SIDE \_\_\_\_\_ FT.

BUILDING FRONTAGE: FRONT 90 FT. SIDE 130' FT.

TRAFFIC LANE: FRONT 4 FT. SIDE 4 FT.

HEIGHT OF SIGN: 30' FT. CLEARANCE TO GRADE: 14' FT.

AREA OF SIGN: 80 SQ. FT. AREA OF EXISTING SIGNS: 128 SQ. FT.

TOTAL ALLOWED AREA: FRONT 337 SQ. FT. SIDE \_\_\_\_\_ SQ. FT.

### TYPE OF SIGN

- ON PREMISE
- OFF PREMISE
- FREE STANDING
- PROJECTING
- ROOF
- FLUSH WALL
- ILLUMINATED
- OTHER

COMMENTS: Sign on 2 steel poles

### \*SKETCH

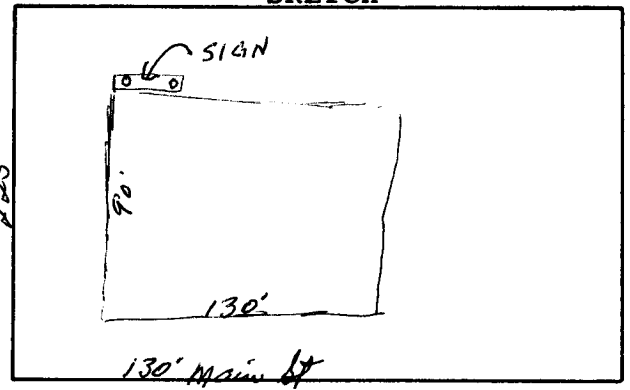

\*Include: Streets, Property Lines, Proposed Sign Location.

PROPERTY OWNER: Castle Creek

ADDRESS: \_\_\_\_\_

CONTRACTOR: Western News

ADDRESS: 456 W. Ave

PHONE: \_\_\_\_\_

[Signature]  
Signature

APPROVED BY: [Signature]

DATE APPROVED: Feb. 5, 1987

- FINAL PERMIT
- WILL REQUIRE SEPARATE PERMIT