

DATE SUBMITTED: 7-31-87

PERMIT # _____

FEE \$ 5.00

SIGN PERMIT

GRAND JUNCTION PLANNING DEPARTMENT

BUSINESS NAME: ASSEMBLIES OF GOD DISTRICT COUNCIL OFFICE

BUSINESS ADDRESS: 1401 N. 1st ST. GRAND JUNCTION, CO

STREET FRONTAGE: FRONT _____ FT. SIDE _____ FT.

BUILDING FRONTAGE: FRONT _____ FT. SIDE _____ FT.

TRAFFIC LANE: FRONT _____ FT. SIDE _____ FT.

HEIGHT OF SIGN: _____ FT. CLEARANCE TO GRADE: _____ FT.

AREA OF SIGN: 15 # & 16 # SQ. FT. AREA OF EXISTING SIGNS: same SQ. FT.
to be replaced

TOTAL ALLOWED AREA: FRONT n/a SQ. FT. SIDE n/a SQ. FT.

TYPE OF SIGN

- ON PREMISE
- OFF PREMISE
- FREE STANDING
- PROJECTING
- ROOF
- FLUSH WALL
- ILLUMINATED existing
- OTHER

COMMENTS replacing existing panels within existing frame work.

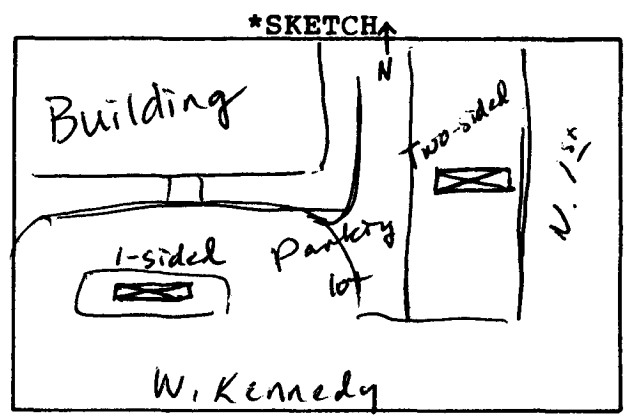

*Include: Streets, Property Lines, Proposed Sign Location.

PROPERTY OWNER: BECKNER

ADDRESS: _____

CONTRACTOR: KC SIGNS (KENN WOODDEN)

ADDRESS: 163 MONTROSE DR MONTROSE, CO

PHONE: (303) 249-0270

[Signature]
Signature

APPROVED BY: M. Sathell

DATE APPROVED: 7-31-87

- FINAL PERMIT
- WILL REQUIRE SEPARATE PERMIT