

DATE SUBMITTED: 3/23/88

PERMIT # _____

FEE 5⁰⁰

SIGN PERMIT

GRAND JUNCTION PLANNING DEPARTMENT

BUSINESS NAME: Ho Fer Foods

BUSINESS ADDRESS: 102 No. Ave

STREET FRONTAGE: FRONT 146 FT. SIDE 104 FT.

BUILDING FRONTAGE: FRONT 60 FT. SIDE 20 FT.

TRAFFIC LANE: FRONT 4 FT. SIDE 4 FT.

HEIGHT OF SIGN: 22' FT. CLEARANCE TO GRADE: 6' FT.

AREA OF SIGN: 184' SQ. FT. AREA OF EXISTING SIGNS: 108 SQ. FT.

TOTAL ALLOWED AREA: FRONT 219 SQ. FT. SIDE 156 SQ. FT.

TYPE OF SIGN

- | | |
|---|---|
| <input checked="" type="checkbox"/> ON PREMISE | <input type="checkbox"/> ROOF |
| <input type="checkbox"/> OFF PREMISE | <input type="checkbox"/> FLUSH WALL |
| <input checked="" type="checkbox"/> FREE STANDING | <input checked="" type="checkbox"/> ILLUMINATED |
| <input type="checkbox"/> PROJECTING | <input type="checkbox"/> OTHER |

COMMENTS Price sign on steel pole
under Ho Fer Foods sign

*SKETCH

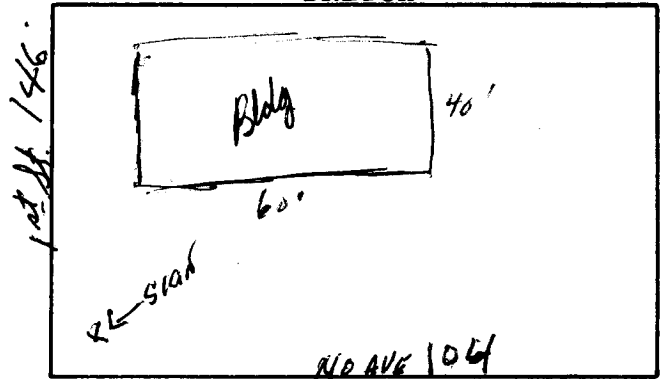

*Include: Streets, Property Lines, Proposed Sign Location.

PROPERTY OWNER: Ho Fer Foods

ADDRESS: 102 No. Ave

CONTRACTOR: Weston Snow Co.

ADDRESS: 456 No. Ave

PHONE: 242-7893

Steve Mickey
Signature

APPROVED BY: Linde

DATE APPROVED: 3-23-88

- FINAL PERMIT
- WILL REQUIRE SEPARATE PERMIT