

DATE SUBMITTED: 5-10-89

PERMIT # \_\_\_\_\_

FEE 10<sup>00</sup>

# SIGN PERMIT

GRAND JUNCTION PLANNING DEPARTMENT

BUSINESS NAME: A-1 Muffler

BUSINESS ADDRESS: 340 S 13TH

STREET FRONTAGE: FRONT ~~337.5~~ <sup>225</sup> FT. SIDE \_\_\_\_\_ FT.

BUILDING FRONTAGE: FRONT 90 FT. SIDE 35 FT.

TRAFFIC LANE: FRONT (2) FT. SIDE \_\_\_\_\_ FT.

HEIGHT OF SIGN: 25 FT. CLEARANCE TO GRADE: \_\_\_\_\_ FT.

AREA OF SIGN: 56 SQ. FT. AREA OF EXISTING SIGNS: 192 SQ. FT.

TOTAL ALLOWED AREA: FRONT 337.5 SQ. FT. SIDE \_\_\_\_\_ SQ. FT.

### TYPE OF SIGN

- ON PREMISE
- OFF PREMISE
- FREE STANDING
- PROJECTING
- ROOF
- FLUSH WALL
- ILLUMINATED
- OTHER

COMMENTS \_\_\_\_\_

### \*SKETCH

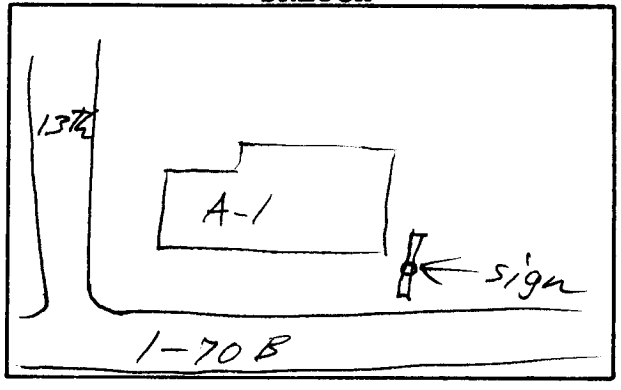

\*Include: Streets, Property Lines, Proposed Sign Location.

PROPERTY OWNER: Frank Russell

ADDRESS: Grand Jct.

CONTRACTOR: Grand Jct. Sign & Neon

ADDRESS: 2915 Hill Av.

PHONE: 245-2950

Randy Orem  
Signature

APPROVED BY: Linda

DATE APPROVED: 5-10-89

- FINAL PERMIT
- WILL REQUIRE SEPARATE PERMIT