

DATE SUBMITTED: 6-8-88

PERMIT # _____

FEE 20⁰⁰

SIGN PERMIT

GRAND JUNCTION PLANNING DEPARTMENT

BUSINESS NAME: THE BRICK YARD

BUSINESS ADDRESS: 454 28 1/2 ROAD

STREET FRONTAGE: FRONT 182' FT. SIDE 150' FT.

BUILDING FRONTAGE: FRONT 33' FT. SIDE ~~88~~ 113' FT.

TRAFFIC LANE: FRONT 4 LANE FT. SIDE _____ FT.

HEIGHT OF SIGN: _____ FT. CLEARANCE TO GRADE: _____ FT.

AREA OF SIGN: 242 SQ. FT. AREA OF EXISTING SIGNS: 32 SQ. FT.

TOTAL ALLOWED AREA: ^{BUILDING} FRONT 272 SQ. FT. SIDE OFF LOT SIZE (POLE SIGN) SQ. FT.
COMBINED

TYPE OF SIGN

- ON PREMISE
- OFF PREMISE
- FREE STANDING
- PROJECTING
- ROOF
- FLUSH WALL
- ILLUMINATED
- OTHER

COMMENTS Roof sign re: Section
5-7-7-B S.E. Look Like Part
of Roof

*SKETCH

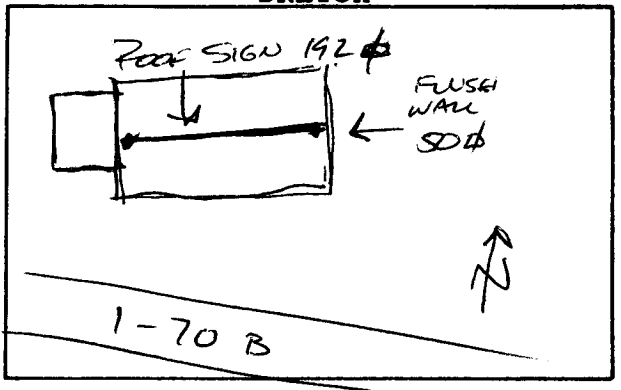

*Include: Streets, Property Lines, Proposed Sign Location.

PROPERTY OWNER: STAN JOHNSON

ADDRESS: 454 28 1/2 RD.

CONTRACTOR: BUD'S SIGNS

ADDRESS: 1055 UTE

PHONE: 245-7700

[Signature]
Signature

APPROVED BY: Linde

DATE APPROVED: 6/8/88

- FINAL PERMIT
- WILL REQUIRE SEPARATE PERMIT