

DATE SUBMITTED: 3/31/88

PERMIT # _____

FEE \$ 5.00

SIGN PERMIT

GRAND JUNCTION PLANNING DEPARTMENT

BUSINESS NAME: A-1 Auto Sales

BUSINESS ADDRESS: 1025 S. 5th St.

STREET FRONTAGE: FRONT 175 FT. SIDE 125 FT.

BUILDING FRONTAGE: FRONT 55 FT. SIDE 35 FT.

TRAFFIC LANE: FRONT 4 FT. SIDE 2 FT.

HEIGHT OF SIGN: N/A FT. CLEARANCE TO GRADE: N/A FT.

AREA OF SIGN: 48 SQ. FT. AREA OF EXISTING SIGNS: 34 SQ. FT.

TOTAL ALLOWED AREA: FRONT 262.50 SQ. FT. SIDE _____ SQ. FT.

TYPE OF SIGN

- ON PREMISE
- OFF PREMISE
- FREE STANDING
- PROJECTING
- ROOF
- FLUSH WALL
- ILLUMINATED
- OTHER

COMMENTS _____

*SKETCH

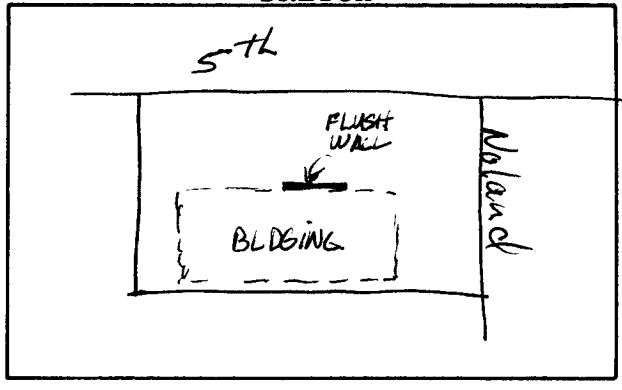

*Include: Streets, Property Lines, Proposed Sign Location.

PROPERTY OWNER: Pat Belcastro

ADDRESS: 1025 S. 5th St.

CONTRACTOR: CWOA

ADDRESS: P.O. 2806

PHONE: 242 - 5248

Roy L. Sample
Signature

APPROVED BY: Sid

DATE APPROVED: 4/14/88

- FINAL PERMIT
- WILL REQUIRE SEPARATE PERMIT