

No Elec

DATE SUBMITTED: 2/9/88

PERMIT # \_\_\_\_\_

FEE \$ 10.00

# SIGN PERMIT

GRAND JUNCTION PLANNING DEPARTMENT

BUSINESS NAME: Western Slope Chrysler Dodge Plymouth

BUSINESS ADDRESS: 2566 Hwy 6 & 50

STREET FRONTAGE: FRONT 240' FT. SIDE 425' FT.

BUILDING FRONTAGE: FRONT 140' FT. SIDE 225' FT.

TRAFFIC LANE: FRONT 4 FT. SIDE 2 FT.

HEIGHT OF SIGN: \_\_\_\_\_ FT. CLEARANCE TO GRADE: \_\_\_\_\_ FT.

AREA OF SIGN: 76' 140' SQ. FT. AREA OF EXISTING SIGNS: 130 SQ. FT.

TOTAL ALLOWED AREA: <sup>POLE SIGN</sup> FRONT 211 SQ. FT. <sup>BLDG</sup> SIDE 315' SQ. FT.

### TYPE OF SIGN

- ON PREMISE
- OFF PREMISE
- FREE STANDING
- PROJECTING
- ROOF
- FLUSH WALL
- ILLUMINATED
- OTHER

COMMENTS Sign on Bldg

### \*SKETCH

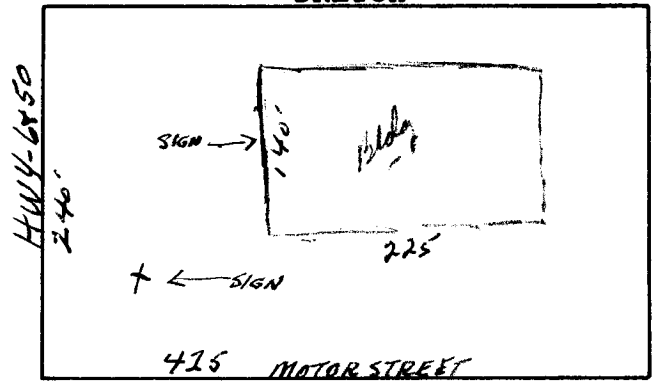

\*Include: Streets, Property Lines, Proposed Sign Location.

PROPERTY OWNER: Western Slope Auto

ADDRESS: 2566 Hwy 6 & 50

CONTRACTOR: Western News Co

ADDRESS: 456 No Ave

PHONE: \_\_\_\_\_

[Signature]  
Signature

APPROVED BY: [Signature]

DATE APPROVED: 2-9-88

- FINAL PERMIT
- WILL REQUIRE SEPARATE PERMIT