

DATE SUBMITTED: 2-9-88

PERMIT # _____

FEE \$ 5.00

SIGN PERMIT

GRAND JUNCTION PLANNING DEPARTMENT

BUSINESS NAME: Kathy's Car Wash Conoco

BUSINESS ADDRESS: 2823 No. Ave

STREET FRONTAGE: FRONT 120' FT. SIDE 175' FT.

BUILDING FRONTAGE: FRONT 66' FT. SIDE 75' FT.

TRAFFIC LANE: FRONT 4 FT. SIDE 2 FT.

HEIGHT OF SIGN: 11' FT. CLEARANCE TO GRADE: _____ FT.

AREA OF SIGN: 44 SQ. FT. AREA OF EXISTING SIGNS: 40 SQ. FT.

TOTAL ALLOWED AREA: FRONT 180 SQ. FT. SIDE _____ SQ. FT.

TYPE OF SIGN

- ON PREMISE
- OFF PREMISE
- FREE STANDING
- PROJECTING
- ROOF
- FLUSH WALL
- ILLUMINATED
- OTHER

COMMENTS Sign on steel pole

*SKETCH

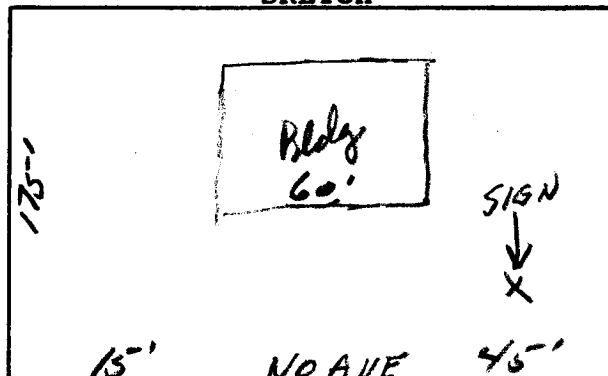

*Include: Streets, Property Lines, Proposed Sign Location.

PROPERTY OWNER: Kathy's Car Wash

ADDRESS: 2823 No. Ave

CONTRACTOR: Western News Co

ADDRESS: 456 No. Ave

PHONE: _____

[Signature]
Signature

APPROVED BY: Linde

DATE APPROVED: 2-9-88

- FINAL PERMIT
- WILL REQUIRE SEPARATE PERMIT