

DATE SUBMITTED: 5/24/89

PERMIT # _____

FEE 10.00

" 2
2995-143-25-003

SIGN PERMIT

GRAND JUNCTION PLANNING DEPARTMENT

BUSINESS NAME: The Bayou

BUSINESS ADDRESS: 159 Colo Ave

STREET FRONTAGE: FRONT 50' FT. SIDE 125' FT.

BUILDING FRONTAGE: FRONT 25' FT. SIDE 85' FT.

TRAFFIC LANE: FRONT 2 FT. SIDE 2 FT.

HEIGHT OF SIGN: _____ FT. CLEARANCE TO GRADE: _____ FT.

AREA OF SIGN: Colo Ave - 185 sq. ft.
2nd St. - 105 sq. ft. SQ. FT. AREA OF EXISTING SIGNS: 0 SQ. FT.

TOTAL ALLOWED AREA: FRONT 50 SQ. FT. SIDE 170 SQ. FT.
Flush wall

TYPE OF SIGN

- ON PREMISE
- OFF PREMISE
- FREE STANDING
- PROJECTING
- ROOF
- FLUSH WALL
- ILLUMINATED
- OTHER

COMMENTS (Neon) enclosed signs.
for Flush wall mount

*SKETCH

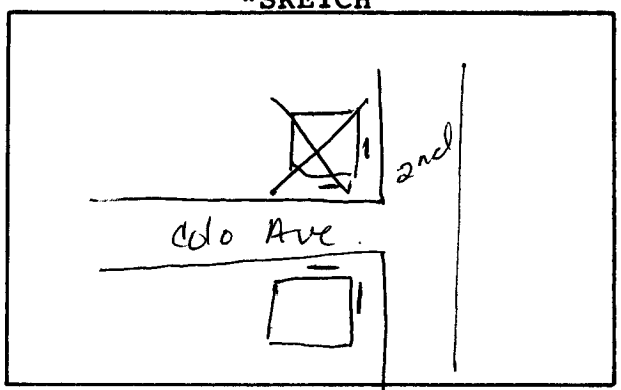

*Include: Streets, Property Lines, Proposed Sign Location.

PROPERTY OWNER: X Steven Beham

Sondia G. Nichols
Signature

ADDRESS: X 210 1/2 6th. Glenwood Spruce 81601.

CONTRACTOR: Grand Jet Signs & Neon

ADDRESS: 2915 Hill Ave G. Jet CO

APPROVED BY: Kathy Padua

PHONE: 245-2950

DATE APPROVED: 5/24/89

- FINAL PERMIT
- WILL REQUIRE SEPARATE PERMIT