

DATE SUBMITTED: 10-6-89

PERMIT # _____

FEE # 5 ⁰⁹

SIGN PERMIT

GRAND JUNCTION PLANNING DEPARTMENT

BUSINESS NAME: Eastream Candies Inc

BUSINESS ADDRESS: 200 S. 7th St

STREET FRONTAGE: FRONT 195 FT. SIDE 195 FT.

BUILDING FRONTAGE: FRONT _____ FT. SIDE _____ FT.

TRAFFIC LANE: FRONT _____ FT. SIDE _____ FT.

HEIGHT OF SIGN: _____ FT. CLEARANCE TO GRADE: _____ FT.

AREA OF SIGN: 44 SQ. FT. AREA OF EXISTING SIGNS: _____ SQ. FT.

TOTAL ALLOWED AREA: FRONT ~~195~~ 242 SQ. FT. SIDE _____ SQ. FT.

TYPE OF SIGN

- ON PREMISE
- OFF PREMISE
- FREE STANDING
- PROJECTING
- ROOF
- FLUSH WALL
- ILLUMINATED
- OTHER

COMMENTS Same as before

*SKETCH

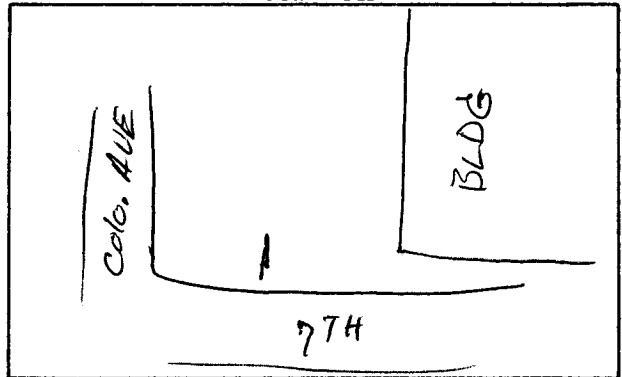

*Include: Streets, Property Lines, Proposed Sign Location.

PROPERTY OWNER: EN-SIM PARTNERSHIP Mark Smith
Signature

ADDRESS: 653 ROUNDHILL DR.

CONTRACTOR: WESTERN WELDON CO

ADDRESS: 456 N 1st AVE G.J.

PHONE: 242-7843

APPROVED BY: Ande Litzel

DATE APPROVED: 10-6-89

B&B ELECTRIC

- FINAL PERMIT
- WILL REQUIRE SEPARATE PERMIT