

DATE SUBMITTED: 12-12-89
TAX SCHEDULE #: 2945-111-~~29~~-~~009~~

PERMIT # _____
FEE \$5.00

SIGN PERMIT

GRAND JUNCTION PLANNING DEPARTMENT

BUSINESS NAME: AMERICAN FAMILY INSURANCE

BUSINESS ADDRESS: 1001 PATTERSON ROAD

STREET FRONTAGE: FRONT 90' FT. SIDE — FT.

BUILDING FRONTAGE: FRONT 80' FT. SIDE — FT.

TRAFFIC LANE: FRONT 4 FT. SIDE — FT.

HEIGHT OF SIGN: 16'6" FT. CLEARANCE TO GRADE: 12'6" FT.

AREA OF SIGN: 32 π SQ. FT. AREA OF EXISTING SIGNS: — SQ. FT.

TOTAL ALLOWED AREA: FRONT 135 SQ. FT. SIDE — SQ. FT.

TYPE OF SIGN

- | | |
|---------------------------------------------------|--------------------------------------|
| <input checked="" type="checkbox"/> ON PREMISE | <input type="checkbox"/> ROOF |
| <input type="checkbox"/> OFF PREMISE | <input type="checkbox"/> FLUSH WALL |
| <input checked="" type="checkbox"/> FREE STANDING | <input type="checkbox"/> ILLUMINATED |
| <input type="checkbox"/> PROJECTING | <input type="checkbox"/> OTHER |

COMMENTS NON ILLUMINATED
SINGLE POLE MOUNT

*SKETCH

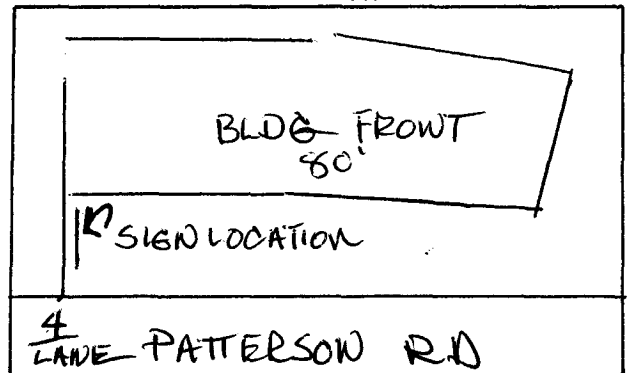

*Include: Streets, Property Lines, Proposed Sign Location.

PROPERTY OWNER: KAY & WANDA JONES
ADDRESS: 1533-2 CRESTVIEW WAY 81506
CONTRACTOR: WESTERN NEON CO.
ADDRESS: 456 NORTH AVE
PHONE: 242-7843

Mark W. Smith
Signature

APPROVED BY: [Signature]
DATE APPROVED: 12/12/89

- FINAL PERMIT
 WILL REQUIRE SEPARATE PERMIT