

DATE SUBMITTED: 3/23/89

PERMIT # _____

FEE 10⁰⁰

SIGN PERMIT

GRAND JUNCTION PLANNING DEPARTMENT

BUSINESS NAME: CHIROPRACTIC PHYSICIANS

BUSINESS ADDRESS: 1445 North 7th St.

STREET FRONTAGE: FRONT 130 FT. SIDE X FT.

BUILDING FRONTAGE: FRONT 40 FT. SIDE X FT.

TRAFFIC LANE: FRONT 4 FT. SIDE X FT.

HEIGHT OF SIGN: 10' FT. CLEARANCE TO GRADE: 6' FT.

AREA OF SIGN: 32 SQ. FT. AREA OF EXISTING SIGNS: X SQ. FT.

TOTAL ALLOWED AREA: FRONT 60 SQ. FT. SIDE X SQ. FT.

TYPE OF SIGN

- ON PREMISE
- OFF PREMISE
- FREE STANDING
- PROJECTING
- ROOF
- FLUSH WALL
- ILLUMINATED
- OTHER

COMMENTS 4'x8' D/F Plex-illum.

*SKETCH

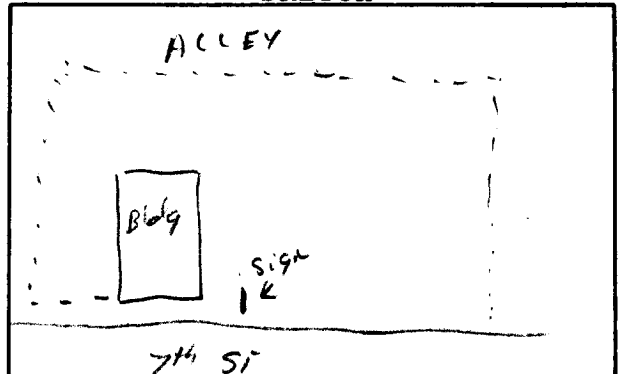

*Include: Streets, Property Lines, Proposed Sign Location.

PROPERTY OWNER: DR. THOMAS DENKER

ADDRESS: 1445 North 7th St.

CONTRACTOR: Western Nav Co.

ADDRESS: 456 North Ave

PHONE: 242-7843

Thomas J. Denker
Signature

APPROVED BY: Archie Witzel

DATE APPROVED: 3/23/89

- FINAL PERMIT
- WILL REQUIRE SEPARATE PERMIT