

DATE SUBMITTED: 11-30-89

PERMIT # _____

FEE \$10.00

SIGN PERMIT

GRAND JUNCTION PLANNING DEPARTMENT

BUSINESS NAME: BENEFICIAL FINANCE

BUSINESS ADDRESS: 1670 NORTH AVE

STREET FRONTAGE: FRONT _____ FT. SIDE _____ FT.

BUILDING FRONTAGE: FRONT 80 FT. SIDE _____ FT.

TRAFFIC LANE: FRONT 4 FT. SIDE _____ FT.

HEIGHT OF SIGN: 14'6" - 15'6" FT. CLEARANCE TO GRADE: 12' - 14'6" FT.

AREA OF SIGN: 153 66th SQ. FT. AREA OF EXISTING SIGNS: 153 SQ. FT.

TOTAL ALLOWED AREA: FRONT 160 SQ. FT. SIDE _____ SQ. FT.

TYPE OF SIGN

- | | |
|---|---|
| <input checked="" type="checkbox"/> ON PREMISE | <input type="checkbox"/> ROOF |
| <input type="checkbox"/> OFF PREMISE | <input checked="" type="checkbox"/> FLUSH WALL |
| <input checked="" type="checkbox"/> FREE STANDING | <input checked="" type="checkbox"/> ILLUMINATED |
| <input type="checkbox"/> PROJECTING | <input type="checkbox"/> OTHER |

COMMENTS: 1 BLDG SIGN
FREE STANDING SIGN

*SKETCH

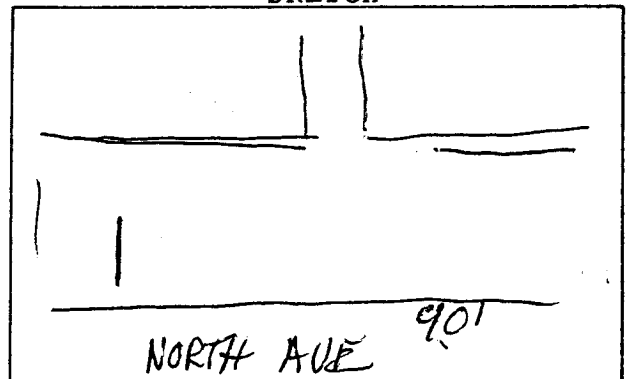

*Include: Streets, Property Lines, Proposed Sign Location.

PROPERTY OWNER: BILL MILLIUS

ADDRESS: 1670 NORTH AVE

CONTRACTOR: WESTERN NEW

ADDRESS: 456 NORTH AVE

PHONE: 242-7843

Mark W. Smith
Signature

APPROVED BY: Kathy M. [Signature]

DATE APPROVED: 11/30/89

- FINAL PERMIT
- WILL REQUIRE SEPARATE PERMIT
electrical