

DATE SUBMITTED: 11-2-89

PERMIT # _____

FEE \$10

SIGN PERMIT

GRAND JUNCTION PLANNING DEPARTMENT

BUSINESS NAME: GRAND Jct. CHIROPRACTIC CENTER

BUSINESS ADDRESS: 12TH ~~ST~~ ORCHARD

STREET FRONTAGE: FRONT _____ FT. SIDE _____ FT.

BUILDING FRONTAGE: FRONT _____ FT. SIDE _____ FT.

TRAFFIC LANE: FRONT _____ FT. SIDE _____ FT.

HEIGHT OF SIGN: 25' FT. CLEARANCE TO GRADE: _____ FT.

AREA OF SIGN: 144 SQ. FT. AREA OF EXISTING SIGNS: _____ SQ. FT.

TOTAL ALLOWED AREA: 143 FRONT _____ SQ. FT. SIDE _____ SQ. FT.

596
OFF EDGE

TYPE OF SIGN

- | | |
|---|---|
| <input checked="" type="checkbox"/> ON PREMISE | <input type="checkbox"/> ROOF |
| <input type="checkbox"/> OFF PREMISE | <input type="checkbox"/> FLUSH WALL |
| <input checked="" type="checkbox"/> FREE STANDING | <input checked="" type="checkbox"/> ILLUMINATED |
| <input type="checkbox"/> PROJECTING | <input type="checkbox"/> OTHER |

COMMENTS See book file 89-7

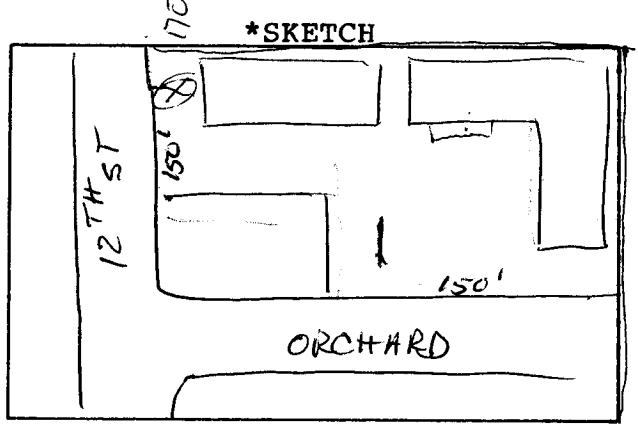

*Include: Streets, Property Lines, Proposed Sign Location.

PROPERTY OWNER: JACK D BERRY

ADDRESS: 327 NORTH 7TH ST.

CONTRACTOR: WESTERN NEON CO.

ADDRESS: 456 NORTH AVE

PHONE: 242-7843

Mark W Smith
Signature

APPROVED BY: Linda Witzel

DATE APPROVED: 11-27-89

B & B ELECTRIC

- FINAL PERMIT
- WILL REQUIRE SEPARATE PERMIT