

DATE SUBMITTED: 3/30/90

PERMIT # _____

TAX SCHEDULE #: 2945-143-02-006

FEE \$10.00

SIGN PERMIT ✓

GRAND JUNCTION PLANNING DEPARTMENT

BUSINESS NAME: Sois' Place

BUSINESS ADDRESS: 241 Grand Avenue

STREET FRONTAGE: FRONT 137.5 FT. SIDE N.A. FT.

BUILDING FRONTAGE: FRONT 78 FT. SIDE N.A. FT.

TRAFFIC LANE: FRONT 4 FT. SIDE N.A. FT.

HEIGHT OF SIGN: 15 FT. CLEARANCE TO GRADE: 8' FT.

AREA OF SIGN: 54th SQ. FT. AREA OF EXISTING SIGNS: 0 SQ. FT.

TOTAL ALLOWED AREA: FRONT 205 SQ. FT. SIDE NA. SQ. FT.

TYPE OF SIGN

- | | |
|---|---|
| <input type="checkbox"/> ON PREMISE | <input type="checkbox"/> ROOF |
| <input type="checkbox"/> OFF PREMISE | <input type="checkbox"/> FLUSH WALL |
| <input checked="" type="checkbox"/> FREE STANDING | <input checked="" type="checkbox"/> ILLUMINATED |
| <input type="checkbox"/> PROJECTING | <input type="checkbox"/> OTHER |

COMMENTS Existing Electrical
- Charge Fees Only -

*SKETCH

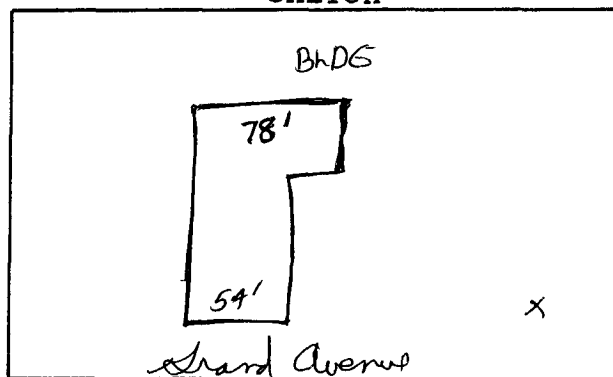

*Include: Streets, Property Lines, Proposed Sign Location.

PROPERTY OWNER: Grand Avenue Drug

ADDRESS: 241 Grand Avenue

CONTRACTOR: Western Nam Co.

ADDRESS: 2483 Commerce Blvd.

PHONE: 242-7643

Jim Cook
Signature

APPROVED BY: Karl Mefner

DATE APPROVED: 3/30/90

- FINAL PERMIT
- WILL REQUIRE SEPARATE PERMIT