

DATE SUBMITTED: 5-1-90

PERMIT # _____

FEE \$ 20⁰⁰

SIGN PERMIT

TAX Sch #
2945 14317007

GRAND JUNCTION PLANNING DEPARTMENT

BUSINESS NAME: Mesa National Bank 131 N. 6th St

BUSINESS ADDRESS: 6th Road

STREET FRONTAGE: road FRONT 125 FT. 6th SIDE 120 FT.

BUILDING FRONTAGE: FRONT 100 FT. 200 SIDE 115 FT. 230

TRAFFIC LANE: FRONT 4 FT. SIDE 2 FT.

HEIGHT OF SIGN: 4 FT. CLEARANCE TO GRADE: _____ FT.

AREA OF SIGN: 40 SQ. FT. AREA OF EXISTING SIGNS: 40 SQ. FT.

TOTAL ALLOWED AREA: FRONT 200 SQ. FT. SIDE 230 SQ. FT.
road 15 ft

TYPE OF SIGN

- ON PREMISE
- OFF PREMISE
- FREE STANDING
- PROJECTING
- ROOF
- FLUSH WALL
- ILLUMINATED
- OTHER

COMMENTS remove old letter - "Federal Saving"
INSTALL New Letters "NATIONAL BANK"

*SKETCH

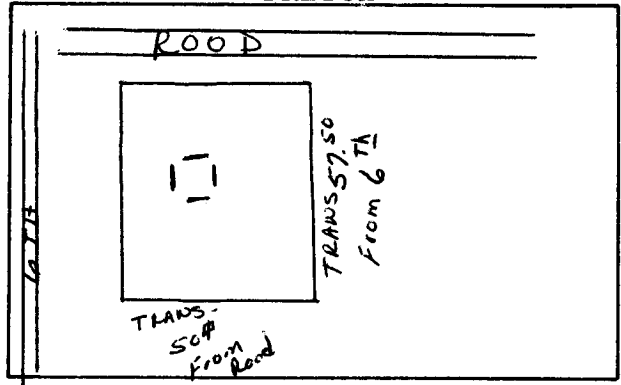

*Include: Streets, Property Lines, Proposed Sign Location.

PROPERTY OWNER: Mesa Federal Sv
 ADDRESS: PO Box 1508 MS, Co
 CONTRACTOR: 2975 Grand Jet Sign
 ADDRESS: 2915 Hill Ave
 PHONE: 245-2950

Bubba Patton
Signature

APPROVED BY: Linda Weitzel

DATE APPROVED: _____

- FINAL PERMIT
- WILL REQUIRE SEPARATE PERMIT

MESA
NATIONAL BANK

4'

10'