

DATE SUBMITTED: 11/27/90

PERMIT # _____

2945-143-21-003

FEE 15.00

SIGN PERMIT

GRAND JUNCTION PLANNING DEPARTMENT

BUSINESS NAME: OFF THE WALL

BUSINESS ADDRESS: 411 MAIN

STREET FRONTAGE: FRONT _____ FT. SIDE _____ FT.

BUILDING FRONTAGE: FRONT 28' 25" FT. SIDE _____ FT.

TRAFFIC LANE: FRONT _____ FT. SIDE _____ FT.

HEIGHT OF SIGN: 3' FT. CLEARANCE TO GRADE: _____ FT.

AREA OF SIGN: ~~27.5~~ 21 SQ. FT. AREA OF EXISTING SIGNS: 28 ~~30~~ SQ. FT.

TOTAL ALLOWED AREA: FRONT 50 SQ. FT. SIDE _____ SQ. FT.

TYPE OF SIGN

- ON PREMISE
- OFF PREMISE
- FREE STANDING
- PROJECTING
- ROOF
- FLUSH WALL
- ILLUMINATED *N/A*
- OTHER

COMMENTS: ~~CHANGED LETTERS~~
Painted - MDU

TAX SCH# 2945-143-21-003

PROPERTY OWNER: Thomas Golden

ADDRESS: 464 N Scherwood Dr G. J.

CONTRACTOR: Grand Jet Sign + Neon

ADDRESS: 2915 Hill Ave

PHONE: 242-2950

CONTRACTOR # 2900244
Brinkley # 38

*SKETCH

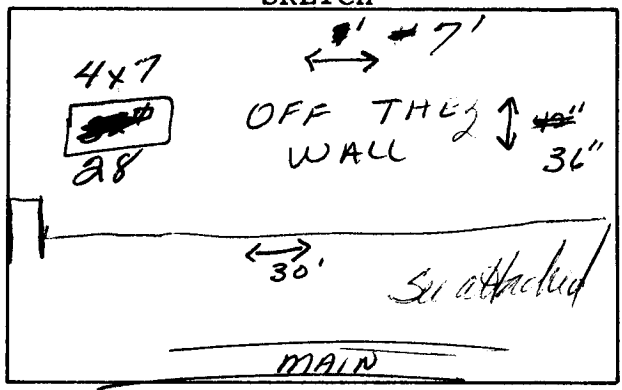

*Include: Streets, Property Lines, Proposed Sign Location.

Barbara Patton
Signature

APPROVED BY: Katlynn Patton

DATE APPROVED: 11/27/90

- FINAL PERMIT
- WILL REQUIRE SEPARATE PERMIT

DESCRIPTION
JOB COST PR.
QUANTITY
MATERIAL

3
16
OFTEN THESE
WARRANTS